



**AMERICAN BOARD
OF VETERINARY
PRACTITIONERS**

**15TH ANNUAL
ABVP SYMPOSIUM**

**WESTIN TABOR CENTER
DENVER COLORADO**

**O N S I T E
P R O G R A M**

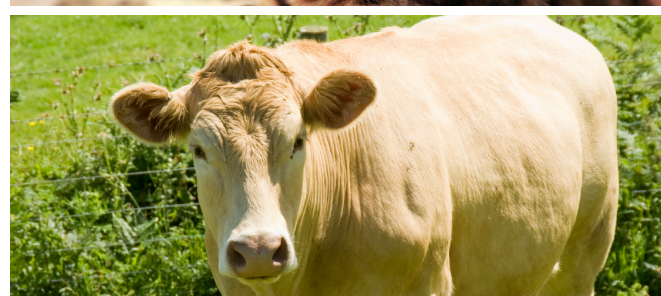
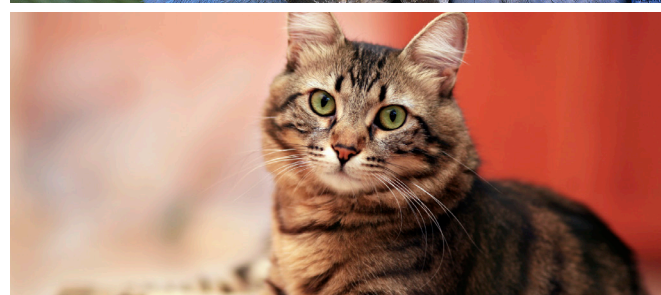
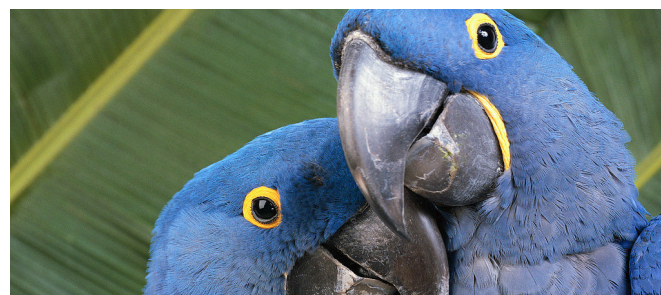

GENERAL INFORMATION

NAME BADGES

Name badges will be required for participation in all sessions, luncheons and exhibit hall. Badges may be picked up at the registration desk during the hours listed.

CANCELLATIONS

Cancellations and refunds are no longer permitted. Should you want to sell your ABVP Annual Dinner or zoo tour tickets, you can do so by posting them on the bulletin board.

CONTINUING EDUCATION CREDITS

Attendees of the conference can earn 23.0 plus hours of Continuing Education. Certificates are included in your conference materials.

Thursday, April 15:	6.0 hours
Friday, April 16:	8.0 hours
Saturday, April 17:	6.0 hours
Sunday, April 18:	3.0 hours

EXHIBITS

Please be sure to visit our sponsors and exhibitors. Through their continued support, we are able to offer quality programs and still keep registration costs reasonable.

Friday, April 16:	12:00pm – 4:30pm
Saturday, April 17:	7:30am – 4:30pm
Sunday, April 18:	7:30am – 11:00am

REGISTRATION DESK HOURS

Wednesday, April 14:	2:00pm – 5:00pm
Thursday, April 15:	10:00am – 5:00pm
Friday, April 16:	7:00am – 4:00pm
Saturday, April 17:	7:00am – 4:00pm
Sunday, April 18:	7:00am – 1:00pm

ITEM WRITING WORKSHOP

Friday, April 16, 7:30pm – 9:00pm. ABVP Diplomates interested in writing exam items to earn credits toward recertification must receive training in item writing. This workshop will focus on item style, cognitive levels, situational sets and other item writing basics.

CERTIFICATION WORKSHOP

Saturday, April 17, 6:00pm – 6:50pm. Attendees considering ABVP certification are invited to participate in this complimentary workshop. Topics will include application and case report presentation, study tips, deadlines, fees and examination structure.

LASER LAB

Thursday, April 15, 6:00pm – 8:00pm. Learn how thousands of practices perform surgeries that cause less pain, less bleeding and less swelling.

NETWORKING LUNCHEONS

Friday and Saturday, April 16-17, 12:30pm – 1:30pm. ABVP's highly rated networking luncheons will provide an opportunity to discuss current issues and network with your

colleagues at the Saturday luncheon. Dr. Kevin Fitzgerald will present a brief program at the Friday luncheon.

ANNUAL SYMPOSIUM DINNER & FUN NIGHT

Saturday, April 17, 7:30pm – 10:00pm. Join your fellow colleagues for a great evening of fun, food and entertainment as we honor our new ABVP Diplomates. The evening will begin at the Westin Tabor Center with a cocktail reception at 7:00pm and dinner at 7:30pm.

Dinner sponsored by  Bayer

ENTERTAINMENT: "The Complete Entertainer", Jolly Demis' spontaneous wit and unique ability to involve every member of the audience leaves his ever-growing roster of fans with a smile on their face, a song in their heart, and wanting just a little bit more!

'BEHIND THE SCENES' DENVER ZOO TOUR

Thursday, April 15, 3:30pm – 5:30pm. (Transportation provided) ABVP Diplomate Kevin Fitzgerald, a Board Member of the Denver Zoo, has graciously invited you to get a look of the Zoo that few ever see. Departure from hotel at 3:00pm and return by 6:00pm.

WELCOME RECEPTION

Friday, April 17, 6:00pm – 7:30pm Sponsored by 

HOTEL FLOOR MAP — Room locations are listed beside the events or below the name of the specialty track —

Mezzanine Level, Third Floor

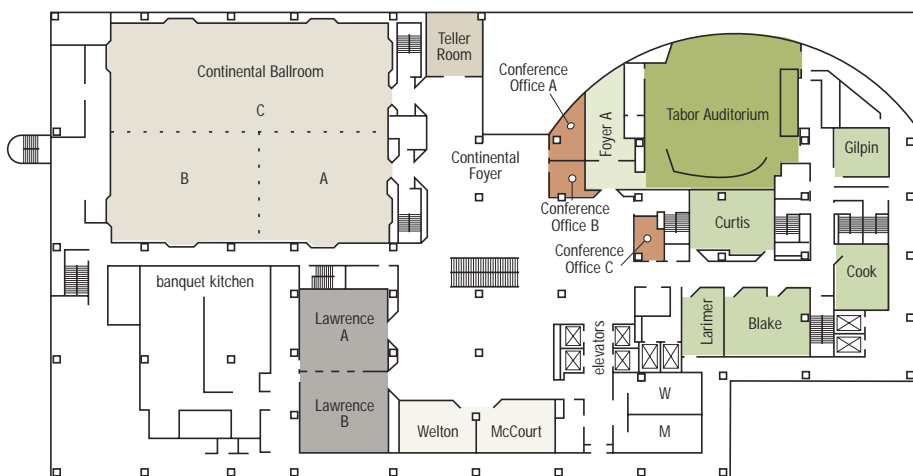

Lobby Level

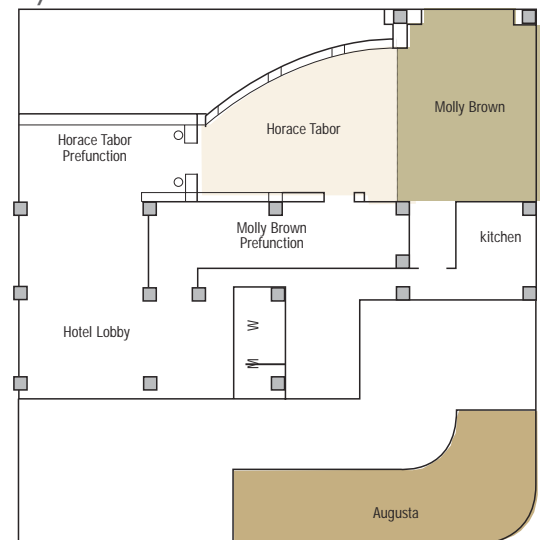

THURSDAY-APRIL 15, 2010

1:00pm-5:00pm	CROSS SPECIES: ABVP/AAHA KICK-OFF SEMINAR: PRISM™ INVENTORY EDUCATION (TABOR AUDITORIUM) <i>Speaker: Angela Schneider Sponsored by AAHA MarketLink/MWI</i>
3:30pm-5:30pm	'BEHIND THE SCENES' DENVER ZOO TOUR <i>Leave from hotel lobby at 3:00pm and return at 6:00pm. Transportation provided.</i>
6:00pm-8:00pm	LASER LAB: A FUN, HANDS-ON INTRODUCTION TO SURGICAL LASERS AND HOW THEY'VE CHANGED THE PROFESSION (CONTINENTAL A) Sponsored by Aesculight

FRIDAY-APRIL 16, 2010

7:00am-8:00am	SUNRISE SESSION: ADVANCING PET WELLNESS THROUGH PREBIOTICS AND PROBIOTICS (with Complementary Continental Breakfast 6:30-8am) (TABOR AUDITORIUM) <i>Speaker: Jörg Steiner Sponsored by P&G Pet Care, Eukanuba and IAMS Veterinary Formulas</i>					
8:00am-12:00pm	CROSS SPECIES: "SUPERBUGS" - UNDERSTANDING, REACTING TO AND AVOIDING "R" (TABOR AUDITORIUM) (10 minute break each hour) <i>Michael Apley</i>					
12:00pm-12:30pm	EXHIBIT HALL OPENING (MEZZANINE FOYER)					
12:30pm-1:30pm	NETWORKING LUNCHEON: ANTARCTICA AND THE POLAR BEARS (CONTINENTAL C) <i>Speaker: Dr. Kevin Fitzgerald</i>					
	AVIAN LAWRENCE B	SMALL RUMINANT LAWRENCE A	CANINE CONTINENTAL A	EQUINE HORACE TABOR	EXOTIC COMPANION MAMMALS BLAKE	FELINE CONTINENTAL B
1:30pm-2:30pm	Diseases and Pathophysiology of the Avian Gastrointestinal Tract I <i>James Morrissey</i>	Gestational Disorders of Sheep and Goats <i>John Middleton</i>	Diagnosis of Cranial Cruciate Disease <i>Jeff Mayo</i>	Equine Lameness: Evaluation and Diagnosis <i>Gary Baxter</i>	Etiology and Physiology of Dental Disease in Elodont Species <i>Angela Lennox</i>	Feline Nutrition: From Science to Practice, Questions and Controversies - Applying Nutrition Principles I Sarah Abood/Margaret Scherk Sponsored by Pfizer
2:30pm-3:00pm	REFRESHMENT BREAK IN EXHIBIT HALL (MEZZANINE FOYER)					
3:00pm-4:00pm	Diseases and Pathophysiology of the Avian Gastrointestinal Tract II <i>James Morrissey</i>	Coccidiosis in South American Camelids <i>John Middleton</i>	Tibial Tuberosity Advancement I: Theory and Procedure <i>Jeff Mayo</i>	Equine Lameness: Foot - Palmar Pastern and Corrective Shoeing I <i>Gary Baxter</i>	Diagnosis of Dental Diseases in Elodont Species <i>Angela Lennox</i>	Feline Nutrition: From Science to Practice, Questions and Controversies - Applying Nutrition Principles II Sarah Abood/Margaret Scherk Sponsored by Pfizer
4:00pm-4:30pm	REFRESHMENT BREAK IN EXHIBIT HALL (MEZZANINE FOYER)					
4:30pm-5:30pm	The Avian Respiratory System: Anatomy, Physiology and Diseases <i>James Morrissey</i>	Camelid Brainteasers: Case Reports <i>John Middleton</i>	Tibial Tuberosity Advancement II: Theory and Procedure <i>Jeff Mayo</i>	Equine Lameness: Foot - Palmar Pastern and Corrective Shoeing II <i>Gary Baxter</i>	Treatment of Dental Disease in Elodont Species <i>Angela Lennox</i>	Feline Nutrition: From Science to Practice, Questions and Controversies - Applying Nutrition Principles III Sarah Abood/Margaret Scherk Sponsored by Pfizer
6:00pm-7:30pm	WELCOME RECEPTION (AUGUSTA) - Sponsored by MERIAL					
7:30pm-9:00pm	ITEM WRITING WORKSHOP (TABOR AUDITORIUM)					

Pictures of Denver used in the brochure are courtesy of Denver CVB

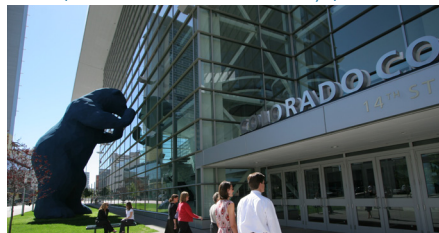

Blue Bear



Denver Art Museum



State Capitol













Civic Center Park



AMERICAN BOARD OF VETERINARY PRACTITIONERS

15th Annual ABVP Symposium • April 15-18, 2010 • Denver, CO

SATURDAY - APRIL 17, 2010

	AVIAN / REPTILE & AMPHIBIAN LAWRENCE B	BOVINE LAWRENCE A	CANINE CONTINENTAL A	EQUINE HORACE TABOR	EXOTIC COMPANION MAMMALS BLAKE	FELINE CONTINENTAL B
7:30am-8:00am	COFFEE IN EXHIBIT HALL (MEZZANINE FOYER)					
8:00am-9:00am	The Avian Respiratory System: Anatomy, Physiology and Diseases <i>James Morrissey</i>	Milk Microbiology for the Practitioner <i>John Middleton</i>	The Lateral Suture Method for Cranial Cruciate Repair I <i>Jeff Mayo</i>	Equine Lameness: Ultrasonography, Radiography, MRI I <i>Natasha Werpy</i>	Diagnosis and Treatment of Dental Abscess in Elodont Species <i>Angela Lennox</i>	Feline Nutrition: From Science to Practice, Questions and Controversies - Evaluation of Products I Sarah Abood/Margaret Scherk Sponsored by 
9:00am-9:30am	REFRESHMENT BREAK IN EXHIBIT HALL (MEZZANINE FOYER)					
9:30am-10:30am	Avian Hematology and Transfusion Medicine I <i>James Morrissey</i>	Mastitis Pathogens in the Dairy Heifer <i>John Middleton</i>	The Lateral Suture Method for Cranial Cruciate Repair II <i>Jeff Mayo</i>	Equine Lameness: Ultrasonography, Radiography, MRI II <i>Natasha Werpy</i>	Etiology, Physiology and Diagnosis of Dental Disease in Non-Elodont Species <i>Angela Lennox</i>	Feline Nutrition: From Science to Practice, Questions and Controversies - Evaluation of Products II Sarah Abood/Margaret Scherk Sponsored by 
10:30am-11:00am	REFRESHMENT BREAK IN EXHIBIT HALL (MEZZANINE FOYER)					
11:00am-12:00pm	Avian Hematology and Transfusion Medicine II <i>James Morrissey</i>	Extra Label Drug Use (ELDU) in Dairy Cattle <i>John Middleton</i>	Small Animal Applications of Radiosurgery <i>Jeff Mayo</i> Sponsored by 	Equine Lameness: Digital Sheath/ Annular Ligament <i>Laurie Goodrich</i>	Treatment of Dental Disease in Non-Elodont Species <i>Angela Lennox</i>	Feline Nutrition: From Science to Practice, Questions and Controversies - Evaluation of Products III Sarah Abood/Margaret Scherk Sponsored by 
12:00pm-12:30pm	REFRESHMENT BREAK IN EXHIBIT HALL (MEZZANINE FOYER)					
12:30pm-1:30pm	NETWORKING LUNCHEON (CONTINENTAL C)					
1:30pm-2:30pm	Amphibian Infectious Diseases I <i>Eric Klaphake</i>	Adding Beef Production Medicine to Your Lateral Practice Toolbox <i>Mark Hilton</i>	Canine Vaccination: Update on the 2010 AAHA Vaccine Guidelines <i>Rich Ford</i> Sponsored by 	Equine Lameness: Flexor Tendons <i>Laurie Goodrich</i>	Respiratory Physiology and Diseases of Exotic Companion Mammals I <i>Cheryl Greenacre</i>	Feline Nutrition: From Science to Practice, Questions and Controversies - Patient Assessment I Sarah Abood/Margaret Scherk Sponsored by 
2:30pm-3:00pm	REFRESHMENT BREAK IN EXHIBIT HALL (MEZZANINE FOYER)					
3:00pm-4:00pm	Amphibian Infectious Diseases II <i>Eric Klaphake</i>	Marketing a Beef Cow/Calf Production Medicine Program I <i>Mark Hilton</i>	Canine Vaccination: Current Issues and Controversies <i>Rich Ford</i> Sponsored by 	Equine Lameness: Intrasynovial Therapy <i>Laurie Goodrich</i>	Respiratory Physiology and Diseases of Exotic Companion Mammals II <i>Cheryl Greenacre</i>	Feline Nutrition: From Science to Practice, Questions and Controversies - Patient Assessment II Sarah Abood/Margaret Scherk Sponsored by 
4:00pm-4:30pm	REFRESHMENT BREAK IN EXHIBIT HALL (MEZZANINE FOYER)					
4:30pm-5:30pm	Reptile/ Amphibian Nutrition <i>Eric Klaphake</i>	Marketing a Beef Cow/Calf Production Medicine Program II <i>Mark Hilton</i>	Canine Lyme Borreliosis: Diagnosis, Treatment, and Prevention <i>Rich Ford</i> Sponsored by 	Equine Lameness: Stem Cell Therapy <i>Laurie Goodrich</i>	Respiratory Physiology and Diseases of Exotic Companion Mammals III <i>Cheryl Greenacre</i>	Pearls and Updates from the World of Feline Medicine <i>Margaret Scherk</i> Sponsored by 
6:00pm-6:50pm	DIPLOMATE FORUM (CONTINENTAL C)					
6:00pm-6:50pm	ABVP CERTIFICATION WORKSHOP (TABOR AUDITORIUM)					
7:00pm-7:30pm	RECEPTION (TABOR-MOLLY BROWN PREFUNCTION)					
7:30pm-10:00pm	ANNUAL SYMPOSIUM DINNER AND FUN NIGHT Dinner sponsored by  Entertainment: THE COMPLETE ENTERTAINER Jolly Demis (TABOR-MOLLY BROWN)					

SUNDAY - APRIL 18, 2010

	REPTILE & AMPHIBIAN LAWRENCE B	BOVINE LAWRENCE A	CANINE CONTINENTAL A	EQUINE HORACE TABOR	EXOTIC COMPANION MAMMALS BLAKE	FELINE CONTINENTAL B
7:30am-8:00am	COFFEE IN EXHIBIT HALL (MEZZANINE FOYER)					
8:00am-9:00am	Reproductive Anatomy, Physiology & Disease of Reptiles and Amphibians <i>Eric Klaphake</i>	Adding Beef Cow/Calf Nutrition Consultation To Your Practice Toolbox I <i>Mark Hilton</i>	Canine Infectious Disease Update <i>Rich Ford</i> Sponsored by IDEXX LABORATORIES	Equine Lameness: Suspensory Ligament - Especially Hind Proximal <i>Chris Kawcak</i>	Central Nervous System Diseases of Exotic Companion Mammals I <i>Cheryl Greenacre</i>	Feline Nutrition: From Science to Practice, Questions and Controversies - Nutrient Modifications in the Diet I <i>Sarah Abood/Margaret Scherk</i> Sponsored by Purina
9:00am-9:30am	REFRESHMENT BREAK IN EXHIBIT HALL (MEZZANINE FOYER)					
9:30am-10:30am	Respiratory Anatomy, Physiology & Disease of Reptiles and Amphibians I <i>Eric Klaphake</i>	Adding Beef Cow/Calf Nutrition Consultation To Your Practice Toolbox II <i>Mark Hilton</i>	Chronic Cough in the Dog <i>Rich Ford</i> Sponsored by IDEXX LABORATORIES	Equine Lameness: Surgery - Digital Sheath/Annular Ligament, Hind Proximal Suspensory Ligament <i>Chris Kawcak</i>	Central Nervous System Diseases of Exotic Companion Mammals II <i>Cheryl Greenacre</i>	Feline Nutrition: From Science to Practice, Questions and Controversies - Nutrient Modifications in the Diet II <i>Sarah Abood/Margaret Scherk</i> Sponsored by Purina
10:30am-11:00am	EXHIBIT HALL DRAWING (MEZZANINE FOYER)					
11:00am-12:00pm	Respiratory Anatomy, Physiology, & Disease of Reptiles and Amphibians II <i>Eric Klaphake</i>	Financial Impact of Preconditioning in a Beef Herd <i>Mark Hilton</i>	Town Hall Meeting on Canine Infectious Disease: an Open Forum <i>Rich Ford</i> Sponsored by IDEXX LABORATORIES	Equine Lameness: PRP, ESWT, IRAP, Tildren, Rehabilitation <i>Chris Kawcak</i>	Central Nervous System Diseases of Exotic Companion Mammals III <i>Cheryl Greenacre</i>	Feline Nutrition: From Science to Practice, Questions and Controversies - Nutrient Modifications in the Diet III <i>Sarah Abood/Margaret Scherk</i> Sponsored by Purina

LECTURE DESCRIPTIONS

THURSDAY, APRIL 15

LASER LAB

8:00am – 12:00pm

A Fun, Hands-on Introduction to Surgical Lasers and How They've Changed the Profession

Enjoy a fun and informative introduction to the use of surgical lasers in a small animal practice. Learn how thousands of practices perform everyday surgeries that cause less pain, less bleeding, and less swelling. You will have an opportunity to operate a laser to better understand the technology, and to explore how the clinical miracles of lasers can benefit the patient, the client, the clinician, and your bottom line.

FRIDAY, APRIL 16

SUNRISE SESSION

7:00am – 8:00am Jörg Steiner
Advancing Pet Wellness through Prebiotics and Probiotics

Join this lecture in exploring the significance of gastrointestinal health on immune system function. Learn how prebiotics and probiotics can be valuable

in re-establishing and maintaining gastrointestinal health in your patients.

CROSS SPECIES

8:00am – 12:00pm Michael Apley
Superbugs – Understanding, Reacting To and Avoiding “R”

Using antimicrobial susceptibility testing to target therapy; what you can and cannot conclude from testing. Selecting antimicrobials in any species; Duration of therapy; Site of infection; Toxicity; Drug interactions; Antimicrobial resistance challenges in veterinary medicine; Frontiers in pain assessment: better models for better drugs.

AVIAN

1:30pm – 2:30pm James Morrissey
Diseases and Pathophysiology of the Avian Gastrointestinal Tract I

Starting with the oral cavity and physiology as it pertains to the pathophysiology of the disease process.

3:00pm – 4:00pm James Morrissey
Diseases and Pathophysiology of the Avian Gastrointestinal Tract II

4:30pm – 5:30pm James Morrissey
The Avian Respiratory System: Anatomy Physiology and Diseases

This lecture will discuss disease processes of the upper and lower portions of the avian respiratory tract. References to the unique anatomy and physiology of the avian respiratory tract will be discussed, with emphasis on their relationship to the disorders.

SMALL RUMINANT

1:30pm – 2:30pm John Middleton
Gestational Disorders of Sheep and Goats

This will summarize common medical and surgical disorders of the small ruminants that occur during pregnancy or around the time of parturition.

3:00pm – 4:00pm John Middleton
Coccidiosis in South American Camelids

This will provide an up-to-date review of coccidiosis in South American camelids with a focus on the more pathogenic species of Eimeria.

4:30pm – 5:30pm John Middleton
Camelids Brain-teasers – Case Reports

This will be a presentation of a series of 3 puzzling cases and how use of the problem-oriented approach allowed us to arrive at a diagnosis.



LECTURE DESCRIPTIONS

CANINE

1:30pm – 2:30pm Jeff Mayo
Diagnosis of Cranial Cruciate Disease

This course will review the physical exam and radiographic findings common to dogs with rupture of the cranial cruciate ligament and other common ailments affecting the hind limb. Physical findings including the medial buttress, the sit test, cranial drawer, and cranial tibial thrust will be reviewed.

3:00pm – 4:00pm Jeff Mayo
Tibial Tuberosity Advancement I: Theory and Procedure

This presentation will cover the theory behind this currently popular procedure for repair of a ruptured cranial cruciate ligament. Radiographic measurements for implants, different implants currently available and the pros and cons of meniscectomy will be discussed.

4:30pm – 5:30pm Jeff Mayo
Tibial Tuberosity Advancement II: Theory and Procedure

EQUINE

1:30pm – 2:30pm Gary Baxter
Equine Lameness: Evaluation and Diagnosis

This will focus on lameness diagnosis including local anesthesia. Examples of both forelimb and hindlimb lameness cases will be presented and new information about perineural and intrasynovial anesthesia techniques will be discussed.

3:00pm – 3:30pm Gary Baxter
Equine Lameness: Foot - Palmar Pastern and Corrective Shoeing I

Specific lameness problems within the foot and pastern region will be addressed, emphasizing newer diagnostic techniques. Lastly, foot conformation as it relates to corrective trimming and shoeing will be discussed.

4:30pm – 5:30pm Gary Baxter
Equine Lameness: Foot - Palmar Pastern and Corrective Shoeing II

EXOTIC COMPANION MAMMAL

1:30pm – 2:30pm Angela Lennox
Etiology and Physiology of Dental Disease in Elodont Species

Dental disease occurs in exotic companion mammals, but with increased frequency in Elodont species such as the rabbit and guinea pig. These lectures present what is known about etiology and physiology of dental disease, with emphasis on multi-modal diagnostic modalities including CT, and current treatment strategies.

3:00pm – 4:00pm Angela Lennox
Diagnosis of Dental Disease in Elodont Species

4:30pm – 5:30pm Angela Lennox
Treatment of Dental Disease in Elodont Species

FELINE

1:30pm – 2:30pm . . . Sarah Abood/Margaret Scherk
Feline Nutrition: From Science to Practice, Questions and Controversies – Applying Nutrition Principles I Sponsored by Pfizer

Attendees will be actively engaged in a serious, but entertaining discussion on how to apply nutrition principles in daily feline practice. Topics will include the evaluation of products in the marketplace, patient assessment and evidence for nutrient modifications in the diet. Participants are encouraged to bring their challenging cases and nutritional questions!

3:00pm – 4:00pm . . . Sarah Abood/Margaret Scherk
Feline Nutrition: From Science to Practice, Questions and Controversies – Applying Nutrition Principles II Sponsored by Pfizer

4:30pm – 5:30pm . . . Sarah Abood/Margaret Scherk
Feline Nutrition: From Science to Practice, Questions and Controversies – Applying Nutrition Principles III Sponsored by Pfizer

SATURDAY, APRIL 17

AVIAN

8:00am – 9:00am James Morrissey
The Avian Respiratory System: Anatomy, Physiology and Diseases
See Friday 4:30pm for Description.

9:30am – 10:30am James Morrissey
Avian Hematology and Transfusion Medicine I
This lecture will discuss the identification and function of the cells within the avian hemogram. Indications and administration of transfusions in birds will round out the lecture.

11:00am – 12:00pm James Morrissey
Avian Hematology and Transfusion Medicine II

REPTILE & AMPHIBIAN

1:30pm – 2:30pm Eric Klaphake
Amphibian Infectious Diseases I
This lecture will discuss viral, bacterial, and parasitic diseases seen in pet, zoo, and wildlife amphibians. Emphasis will be placed on clinical signs, modes of transmission, diagnostics, treatment, and prevention. Zoonotic concerns will be addressed as appropriate.

3:00pm – 4:00pm Eric Klaphake
Amphibian Infectious Diseases II

4:30pm – 5:30pm Eric Klaphake
Reptile/Amphibian Nutrition
This lecture will provide practical information on how and what to recommend feeding reptiles and

amphibians, including supportive nutrition during anorexia and disease. Nutritional diseases will be briefly discussed.

BOVINE

8:00am – 9:00am John Middleton
Milk Microbiology for the Practitioner

This will review basic microbiology that is applicable to the private practitioner for diagnosing bovine or ovine intramammary infections.

9:30am – 10:30am John Middleton
Mastitis Pathogens in the Dairy Heifer

This lecture provides a review of the common mastitis pathogens encountered when working up cases of bovine mastitis, their reservoir of infection, treatment, control, and prevention measures.

11:00am – 12:00pm John Middleton
Extra Label Drug Use (ELDU) in Dairy Cattle
Will review the legal guidelines for ELDU in dairy cattle and present some examples of appropriate and inappropriate ELDU on the dairy farm.

1:30pm – 2:30pm Mark Hilton
Adding Beef Production Medicine to Your Lateral Practice Toolbox

Do you want to do more brain work and less back work in your beef practice? This seminar will outline the process to initiate or enhance your ability to provide beef cow-calf consultation services to your top beef clients.

3:00pm – 4:00pm Mark Hilton
Marketing a Beef Cow/Calf Production Medicine Program I

Come to this session to learn how to structure a beef production medicine program AND how to get paid for providing cost-effective advice to your clients. Examples of the economic benefit to herds where changes have been made will be shown.

4:30pm – 5:30pm Mark Hilton
Marketing a Beef Cow/Calf Production Medicine Program II

CANINE

8:00am – 9:00am Jeff Mayo
The Lateral Suture Method for Cranial Cruciate Repair I

This commonly used method will be discussed, including anatomy of the stifle and availability of current implants, such as bone anchors and new suture material. Current theories in suture placement and bone tunneling will be discussed, followed by a short video presentation. Postoperative cases involving complications will be presented. A brief discussion of meniscectomy will be presented.

9:30am – 10:30am Jeff Mayo
The Lateral Suture Method for Cranial Cruciate Repair II

LECTURE DESCRIPTIONS

11:00am – 12:00pm Jeff Mayo

Small Animal Applications of Radiosurgery

Sponsored by 

A brief discussion of how radiosurgery works will be presented to help the attendee improve on the use of this popular piece of equipment. Surgical applications of radiosurgery in small animals will be covered with pictures and video, to include soft tissue, orthopedic, and rigid endoscopic uses.

1:30pm – 2:30pm Rich Ford

Canine Vaccination: Update on 2010 AAHA

Vaccine Guidelines - Sponsored by

This presentation is a succinct overview of the most current AAHA Canine Vaccine Guidelines (2010) and how these recommendations can best be utilized to develop and implement a rational vaccination protocol for dogs. In addition, the presentation addresses representative protocols utilized within the US by veterinary practices that have adopted the AAHA Vaccine Guidelines.

3:00pm – 4:00pm Rich Ford

Canine Vaccination: Current Issues and

Controversies - Sponsored by

This presentation will address a spectrum of vaccine-related topics that have been raised by practices throughout the US concerning the selection and use of vaccine: managing and preventing acute and delayed vaccine adverse reactions, reducing the volume of vaccine for small dogs, rabies immunity vs. rabies law, triennial vaccination, and more.

4:30pm – 5:30pm Rich Ford

Canine Lyme Borrelia: Diagnosis,

Treatment and Prevention - Sponsored by

With the geographic endemicity of canine Lyme Borrelia (aka, Lyme Disease) expanding within the US, this presentation addresses key updates on Lyme Disease diagnosis, clinical manifestations, including Lyme nephropathy, management of the clinical patient, and vaccination indications and controversies.

EQUINE

8:00am – 9:00am Natasha Werpy

Equine Lameness: Ultrasonography,

Radiography, MRI I

This lecture provides information on how to understand an MRI, with comparison to ultrasound and radiographs. The presentation will consist of basic MRI knowledge and will explain how various modalities work together to provide a diagnosis.

9:30am – 10:30am Natasha Werpy

Equine Lameness: Ultrasonography,

Radiography, MRI II

11:00am – 12:00pm Laurie Goodrich

Equine Lameness: Digital Sheath/Annular

Ligament

We will review pathologies involving the annular ligament and the sheath and discuss recent new treatment modalities.

1:30pm – 2:30pm Laurie Goodrich

Equine Lameness: Flexor Tendons

The pathophysiology of flexor tendonitis will be discussed along with current information on new treatments.

3:00pm – 4:00pm Laurie Goodrich

Equine Lameness: Intrasyovial Therapy

Many new advancements have been made in Intrasyovial therapies. New treatment options and how they work will be discussed.

4:30pm – 5:30pm Laurie Goodrich

Equine Lameness: Stem Cell Therapy

What is it, how does it work and what cases are most appropriate?

EXOTIC COMPANION MAMMAL

8:00am – 9:00am Angela Lennox

Diagnosis and Treatment of Dental Abscess in Elodont Species

Dental disease occurs in exotic companion mammals, but with increased frequency in Elodont species such as the rabbit and guinea pig. These lectures present what is known about etiology and physiology of dental disease, with emphasis on multi-modal diagnostic modalities including CT, and current treatment strategies.

9:30am – 10:30am Angela Lennox

Etiology, Physiology and Diagnosis of Dental Disease in Non-Elodont Species

11:00am – 12:00pm Angela Lennox

Treatment of Dental Disease in Non-Elodont species

1:30pm – 2:30pm Cheryl Greenacre

Respiratory Physiology and Diseases of Exotic Companion Mammals I

A discussion of comparative anatomy and physiology followed by various diseases involving the respiratory tract of exotic companion mammals including rabbits, rodents, ferrets, and other species.

3:00pm – 4:00pm Cheryl Greenacre

Respiratory Physiology and Diseases of Exotic Companion Mammals II

4:30pm – 5:30pm Cheryl Greenacre

Respiratory Physiology and Diseases of Exotic Companion Mammals III

FELINE

8:00am – 9:00am . . . Sarah Abood/Margaret Scherk

Feline Nutrition: From Science to Practice, Questions and Controversies – Evaluation

of Products I *Sponsored by* 

Attendees will be actively engaged in a serious, but entertaining, discussion on how to apply nutrition principles in daily feline practice. Topics will include the evaluation of products in the marketplace, patient assessment and evidence for nutrient modifications in the diet. Participants are encouraged to bring their challenging cases and nutritional questions!

9:30am – 10:30am . . Sarah Abood/Margaret Scherk

Feline Nutrition: From Science to Practice, Questions and Controversies – Evaluation

of Products II *Sponsored by* 

11:00am – 12:00pm . . Sarah Abood/Margaret Scherk

Feline Nutrition: From Science to Practice, Questions and Controversies – Evaluation

of Products III *Sponsored by* 

1:30pm – 2:30pm . . Sarah Abood/Margaret Scherk

Feline Nutrition: From Science to Practice, Questions and Controversies – Patient

Assessment I *Sponsored by* 

3:00pm – 4:00pm . . Sarah Abood/Margaret Scherk

Feline Nutrition: From Science to Practice, Questions and Controversies – Patient

Assessment II *Sponsored by* 

4:30pm – 5:30pm . . . Margaret Scherk

Pearls and updates from the World of

Feline Medicine *Sponsored by* 

SUNDAY, APRIL 18

REPTILE & AMPHIBIAN

8:00am – 9:00am Eric Klaphake

Reproductive Anatomy, Physiology, and Disease of Reptiles and Amphibians

This lecture will discuss disease processes of the reptilian and amphibian reproductive tract. References to their unique anatomical and physiological variations from mammals will be discussed, with emphasis on their relationship to commonly seen diseases.

9:30am – 10:30am Eric Klaphake

Respiratory Anatomy, Physiology, and Disease of Reptiles and Amphibians

This lecture will discuss disease processes of the reptilian and amphibian respiratory tract. References to their unique anatomical and physiological variations from mammals will be discussed, with emphasis on their relationship to commonly seen diseases.

11:00am – 12:00pm Eric Klaphake

Respiratory Anatomy, Physiology, and Disease of Reptiles and Amphibians



LECTURE DESCRIPTIONS

BOVINE

8:00am – 9:00am Mark Hilton
Adding Beef Cow/Calf Nutrition

Consultation to Your Practice Toolbox I

Beef cow/calf nutrition advice comes from a variety of sources, and many do not provide adequate science for the client. We will explore how you can become an asset to your herd owners by finding more cost-effective ways to feed the cowherd.

9:30am – 10:30am Mark Hilton
Adding Beef Cow/Calf Nutrition
Consultation to Your Practice Toolbox II

11:00am – 12:00pm Mark Hilton
Financial Impact of Preconditioning in a Beef Herd

We will look at financial data from a herd over the past 11 years and show where profit is made in the preconditioning program. A spreadsheet will be provided to attendees for use in their own practice to see if preconditioning will benefit their clients.

CANINE

8:00am – 9:00am Rich Ford
Canine Infectious Disease Update -

Sponsored by IDEXX LABORATORIES

This presentation centers on the most recent canine infectious diseases issue. A series of short updates on topics such as: Canine influenza ...indicated or not? ...and why; Antibody titers to assess immunity ...helpful? ...or not?; Leptospirosis Diagnosis and Vaccination; Bordetella bronchiseptica vaccination: Intranasal and Parenteral. Topics may change if new and "HOTTER" topics surface.

9:30am – 10:30am Rich Ford
Chronic Cough in the Dog - *Sponsored by IDEXX LABORATORIES*
This presentation centers on one of the most common, and clinically frustrating respiratory

signs in dogs, chronic cough...when the cough is NOT related to pneumonia, neoplasia, or cardiac disease. Chronic bronchial disease in older dogs is a condition that occurs commonly but is still misunderstood and underdiagnosed (or inappropriately treated) in practice. The role of Bordetella bronchiseptica is reviewed along with implications associated with co-infection: such as canine influenza virus (CIV), parainfluenza virus (CPIV), or canine respiratory coronavirus (CRC).

11:00am – 12:00pm Rich Ford
Town Hall Meeting on Canine Infectious Disease: An Open Forum - *Sponsored by IDEXX LABORATORIES*

This 1-hour session is intended to provide participants with an opportunity to present a spectrum of infectious disease questions ranging from tick-borne illnesses, to Canine Infectious Respiratory Disease (CIRD), to vaccination protocols and products.

EQUINE

8:00am – 9:00am Chris Kawcak
Equine Lameness: Suspensory Ligament (Especially Hind Proximal)

Diagnosis and medical management of suspensory ligament desmitis will be discussed.

9:30am – 10:30am Chris Kawcak
Equine Lameness: Surgery - Digital Sheath/Annular Ligament, Hind Proximal Suspensory Ligament

Diagnosis and indications for surgery will be discussed.

11:00am – 12:00pm Chris Kawcak
Equine Lameness: PRP, ESWT, IRAP, Tildren, Rehabilitation

Various therapies for treatment of lameness will be discussed.

EXOTIC COMPANION MAMMAL

8:00am – 9:00am Cheryl Greenacre
Central Nervous System Diseases of Exotic Companion Mammals I

This will be a discussion of diseases involving the central nervous system of exotic companion mammals including rabbits, rodents, ferrets, and other species. Various imaging modalities and techniques will also be discussed.

9:30am – 10:30am Cheryl Greenacre
Central Nervous System Diseases of Exotic Companion Mammals II

11:00am – 12:00pm Cheryl Greenacre
Central Nervous System Diseases of Exotic Companion Mammals III

FELINE

8:00am – 9:00am Sarah Abood/Margaret Scherk
Feline Nutrition: From Science to Practice, Questions and Controversies – Nutrient Modifications in the Diet I *Sponsored by Pfizer*

Attendees will be actively engaged in a serious, but entertaining, discussion on how to apply nutrition principles in daily feline practice. Topics will include the evaluation of products in the marketplace, patient assessment and evidence for nutrient modifications in the diet. Participants are encouraged to bring their challenging cases and nutritional questions!

9:30am – 10:30am Sarah Abood/Margaret Scherk
Feline Nutrition: From Science to Practice, Questions and Controversies – Nutrient Modifications in the Diet II *Sponsored by Pfizer*

11:00am – 12:30pm Sarah Abood/Margaret Scherk
Feline Nutrition: From Science to Practice, Questions and Controversies – Nutrient Modifications in the Diet III *Sponsored by Pfizer*

ABOUT DENVER

Denver is a vibrant city with 300 days of sunshine, brilliant blue skies and breathtaking mountain scenery. Founded in 1858 as a gold mining camp, Denver is located at the base of the majestic Rocky Mountains, 5,280 feet above sea level – exactly one mile high. Today, Colorado's sophisticated capital city is a thriving, cultural metropolis with a growing reputation for fine dining, museums, galleries, theatre and professional sports. Get to know Denver like the locals!

Buffalo Bill Museum & Grave. The final resting spot of the West's most famous scout and showman is located on top of Lookout Mountain. An adjacent museum tells his life story. www.buffalobill.org.

Butterfly Pavilion & Insect Center. The first stand-alone insect zoo in the country, this enclosed tropical paradise has more than 1,200 free-flying butterflies. www.butterflies.org.

Cherry Creek Shopping District. With more than 500 shops and restaurants, this is Denver's largest indoor and outdoor shopping paradise. Shop in the upscale Cherry Creek Shopping Center, or browse along the tree-lined streets of Cherry Creek North.

Denver Museum of Nature & Science. The fourth largest museum of its kind in the country features dinosaur exhibits, gems and treasures from around the world, an IMAX theater, a planetarium and more. www.dmns.org.

Denver Zoo. Home to more than 4,000 animals, this is the fourth most popular zoo in the U.S. Predator Ridge offers a close look at the plains of Africa complete with a pride of lions. www.denverzoo.org.

MillerCoors. The largest single brewery in the world offers free tours and samples to those over 21 years of age. www.MillerCoors.com

The content placed about Denver is courtesy of Denver CVB

SPEAKER-BIOS

Sarah K. Abood, DVM, PhD

Dr. Abood currently serves as the Assistant Dean for Student Programs and as the small animal clinical nutritionist in the Veterinary Teaching Hospital at Michigan State University's College of Veterinary Medicine. She received her Bachelor of Science degree (1984) and Doctor of Veterinary Medicine degree (1988) from Michigan State University. After completing a one-year internship in large animal medicine and surgery at the University of Minnesota, she earned her PhD in 1997 from Ohio State University and from 1994-1999 she worked as a nutrition scientist in Research & Technical Communications at the Ralston Purina Company in St. Louis, Missouri. Her research and teaching interests include nutrition support for small animal patients, obesity prevention and management, client compliance and veterinary ethics. She has co-authored several articles in peer-reviewed journals as well as several book chapters for the *Manual of Veterinary Dietetics*.

Mike Apley, DVM, PhD, DACVCP

Dr. Apley is a Kansas State University DVM with a PhD in physiology (pharmacology). He is a Diplomate of the American College of Veterinary Clinical Pharmacology. His practice background includes two years in general practice in central Kansas and four years in a feedlot consulting/contract research practice based in Greeley, Colorado. Dr. Apley was on the faculty at Iowa State University for nine years. He is currently a professor in the Department of Veterinary Clinical Sciences at Kansas State University. Dr. Apley works with veterinarians throughout the United States concerning the use of drugs in food animals and beef cattle health with an emphasis on feedlots. In addition, he teaches in the beef production medicine, large animal medicine and pharmacology courses. Dr. Apley is a past president of the Academy of Veterinary Consultants and the American College of Veterinary Clinical Pharmacology. He is Director of PharmCATS.

Gary Baxter, VMD, MS, DACVS

Dr. Baxter is currently a professor of surgery at the Veterinary Teaching Hospital at Colorado State University. He received his veterinary degree from the University of Pennsylvania and completed an internship, surgery residency and MS degree at the University of Georgia. Dr. Baxter became a diplomate of the American College of Veterinary Surgeons (ACVS) in 1989. He served as a faculty member at the University of Georgia before joining the College of Veterinary Medicine and Biomedical Sciences at Colorado State University in 1990. His clinical and research interests involve the musculoskeletal system including equine lameness, laminitis, synovial infections, arthroscopy and developmental orthopedic disease in young horses.

Richard Ford, DVM, MS

Dr. Ford is Professor of Medicine in the Dept. of Clinical Sciences, College of Veterinary Medicine at North Carolina State University. He graduated from the Ohio State University after which he practiced small animal and equine medicine. He completed an internal medicine residency at Michigan State University and has held faculty positions at Purdue University and North Carolina State. His clinical interests are in the field of companion animal infectious diseases, vaccines and vaccination. He is the author/editor of 4 books, including the *Handbook of Veterinary*

Procedures and Emergency Treatment, now in its 7th Edition. Dr. Ford is the Past President of the North American Veterinary Conference.

Laurie R. Goodrich, DVM, MS, PhD, DACVS

Dr. Goodrich joined the faculty at Colorado State University, College of Veterinary Medicine in 2005 as an assistant professor in Equine Surgery and Lameness. She obtained her DVM from the University of Illinois and completed an internship in Large Animal Surgery and Medicine at Virginia-Maryland Regional College of Veterinary Medicine. Following her internship, Dr. Goodrich joined the faculty at Virginia for one year as an equine ambulatory clinician before going on to complete her residency in Equine Surgery at the Equine Medical Center in Leesburg, VA. She obtained a Master of Science in Pharmacology during her residency and subsequently joined the large animal surgery faculty at Cornell University's College of Veterinary Medicine where she became Board Certified in Large Animal Surgery in 1999. At Cornell, she rotated as Chief-of-Service for the Orthopedic, Soft Tissue and Emergency Surgery Services. In 2004, she earned a PhD in Cartilage Repair and Gene Therapy. Dr. Goodrich lectures extensively and is a respected author.

Cheryl Greenacre, DVM, DABVP-Avian, DABVP-Exotic Companion Mammal

Dr. Greenacre is currently a Professor in Avian and Zoological Medicine at the University of Tennessee, College of Veterinary Medicine. She graduated from the University of Georgia (1991), completed an Avian and Exotic Animal Internship and Residency at UGA and became ABVP-Avian certified in 1996. After moving from a faculty position at UGA to join UT, Dr. Greenacre has focused on pain research in reptiles and hypothyroidism in birds. She is the immediate past chair of UT's Institutional Animal Care and Use Committee. Dr. Greenacre received her ABVP Exotic Companion Mammal certification in November 2009.

W. Mark Hilton, DVM, DABVP-Beef Cattle

Dr. Hilton is currently Clinical Associate of Beef Production Medicine Professor at Purdue. He received his BS and DVM from Purdue University and is an ABVP Diplomate in Beef Cattle since 1996. Dr. Hilton worked in private practice in Dewitt, Iowa between 1983-1998 (mostly in Food Animal). He joined the Purdue faculty in 1998, teaching Beef Production Medicine to 4th year DVM and 2nd year RVT students on FA Ambulatory calls and teaching Achieving Success in Practice (required business/communications class) to 3rd year DVM students.

Chris Kawcak, DVM, PhD, DACVS

Dr. Kawcak is the current interim head of the Equine Section of Colorado State University. He joined the faculty in 1998 and has been in the clinic at the Veterinary Medical Center since 2006. Dr. Kawcak received his DVM from Colorado State University in 1991. He returned to Colorado State University for his residency and PhD. Dr. Kawcak is an associate professor and spends most of his time in research at the Orthopedic Research Center. Dr. Kawcak's clinical interests include lameness diagnosis and orthopaedic surgery. His research interests include diagnosis and treatment of musculoskeletal disease as well as development of biomechanical models of joint injury.



SPEAKER-BIOS

Eric Klaphake, DVM, DABVP-Avian, DACZM

Dr. Klaphake has been in practice for over ten years. His practice experience includes work at the Columbus Zoo, Knoxville Zoo, University of Tennessee and all-exotic animal practices in Ohio and Utah. Dr. Klaphake also provides veterinary care for ZooMontana in Billings. He is involved in several wildlife research projects, including studies involving wolverines of the Greater Yellowstone Ecosystem and lesser scaup (duck) migration and nesting research. A 1997 Kansas State University graduate, he is board certified zoo medicine (ACZM) and avian practice (DABVP-avian). He is currently the president of the Association of Reptilian and Amphibian Veterinarians. He recently accepted a post as Associate Editor for Review Articles in the *Journal of Avian Medicine and Surgery*.

Angela M. Lennox, DVM, DABVP-Avian

Dr. Lennox is an adjunct professor at Purdue University Department of Clinical Sciences. In 1989 she graduated from Purdue University School of Veterinary Medicine and has practiced exotic animal medicine for nearly 20 years. She is the owner of the Avian and Exotic Animal Clinic of Indianapolis. She was certified as a Diplomate in Avian Practice by the American Board of Veterinary Practitioners in 2003. Dr. Lennox is the past president of the Association of Exotic Mammal Veterinarians, editor of the *Handbook of Rabbit and Rodent Dentistry* and co-author of *Clinical Radiology of Exotic Companion Mammals*.

Jeff Mayo, DVM, CVLS, DABVP-Canine & Feline,

Dr. Mayo graduated with honors from Oregon State University College of Veterinary Medicine (1994). He purchased his first veterinary practice in 1995 in Lynwood, Washington, and his second practice in 2000. Dr. Mayo passed the certification program administered by the Veterinary Surgical Laser Society in 2005. In 2007, Dr. Mayo began teaching and left private practice to focus more on cruciate repair and joint replacement surgery in dogs. He has also taught radiosurgery and rigid endoscopy courses. In 2007, Dr. Mayo was awarded his American Board of Veterinary Practitioners Diplomate status with certification in Canine and Feline Practice. He recently became a fellow of the newly formed North American Academy of Veterinary Orthopedic Surgery.

John Middleton, DVM, PhD, DACVIM-LAIM

Dr. Middleton currently serves on the faculty of the University of Missouri (2001-Present) as an Associate Professor at the Food Animal Medicine and Surgery and as an Assistant Director at the Agricultural Experiment Station in College of Veterinary Medicine. Dr. Middleton received the following: BS in 1990, DVM in 1993 and PhD in 2001 from Washington State University. Also at WSU, he completed his residency from 1995-1999 in Food Animal Medicine and Surgery. He achieved his Diplomate certification from ACVIM LAIM in 1999. From 1993-1995, he conducted a private practice focused predominantly on dairy in Washington State.

James K. Morrissey, DVM, DABVP-Avian

Dr. Morrissey is currently the head of the Exotic Animal Medicine Service at Cornell University College of Veterinary Medicine. He is a 1992 graduate of Cornell and was in private practice and lab animal medicine for two years before doing an internship in exotic pets, wildlife

and zoo animal medicine at Kansas State University. He completed his residency in exotic pet medicine at the Animal Medical Center in New York City and followed with a one year post-doc at the University of Wisconsin. He returned to Cornell in 2002 and enjoys teaching in the classroom and clinics. His research includes epidemiology, prevention, treatment, and control of mastitis in dairy cattle and goats, with a focus on staphylococcal infections, methicillin-resistant staphylococci in humans and animals and transition cow metabolism.

Margaret Scherk, DVM, DABVP-Feline, Editor JFMS

Dr. Scherk is a private practitioner who founded Cats Only Veterinary Clinic in Vancouver, BC in 1986. She graduated from the University of Guelph (1982) with a DVM from the Ontario Veterinary College. In 1995, she became board certified by the American Board of Veterinary Practitioners in the feline category. Dr. Scherk was selected to serve on the Board of the American Association of Feline Practitioners as its President in 2007 and has been a member of the AAEP Feline Vaccine Guidelines Panel since 1995. She founded and co-edits the *Feline Internal Medicine* folder on Veterinary Information Network (VIN), and is the North American editor for the *Journal of Feline Medicine and Surgery*. Of note is her accomplishment of pioneering the use of the Transdermal Fentanyl Patch for the alleviation of pain in companion animals.

Angela Schneider, CVT

Ms. Schneider has focused her veterinary career on supervision, staff training, administration and practice management. Before joining MWI as an In-Clinic Inventory Consultant in 2008, she was the Practice Manager at the Animal Hospital of Oshkosh and was actively involved in the veterinary professional community. She maintains an active membership in VetPartners and the VHMA, and is currently working toward her Certified Veterinary Practice Manager (CVPM) credential. She brings a practical approach to inventory management.

Jörg M. Steiner, Dr.Med.Vet., PhD, DACVIM, DECVIM-CA

Dr. Steiner received both his veterinary degree (1992) and Dr.Med. Vet. degree (1996) from the Ludwig-Maximilians University in Munich, Germany. He also completed an internship in small animal medicine and surgery at the University of Pennsylvania and a residency in small animal internal medicine at Purdue University. In 1996 he achieved board certification with the American College of Veterinary Internal Medicine and the European College of Veterinary Internal Medicine. In 2000, Dr. Steiner received a Ph.D. from Texas A&M University, where he currently serves as associate professor and director of the GI Laboratory.

Natasha Werpy, DVM, DACVR

Dr. Werpy joined Colorado State University in 2004 and currently serves as an assistant professor at the CSU Orthopedic Research Center in the MRI Center. Previously, she worked for the EORC part-time while doing a non-traditional radiology residency, split between CSU and Dr. Norman Rantanen in California. Her DVM degree is from Colorado State University. She also practices as a consultant in reading equine imaging studies. Dr. Werpy received her DACVR in 2005.

For more detailed bios of the speakers go to www.abvp.com



The Red Bank Veterinary Hospital Healthcare Network, which includes emergency, critical care, rehabilitation, and referral hospitals in Tinton Falls, Red Bank, Cherry Hill, Hillsborough, and Linwood is currently accepting applications for a full-time Avian and Exotics Clinician to join the team at our Tinton Falls location. Applicants must be board certified or have completed residency training.

Our facility includes a dedicated exotics ward and promotes close interaction with more than 20 additional specialists. Imaging modalities available include Digital Radiography, Ultrasound, Fluoroscopy, Helical Computed Tomography (CT), and Scanning and Magnetic Resonance Imaging (MRI). We offer a wide range of soft tissue and orthopedic procedures as well as endoscopic evaluation of oral and nasal cavities, upper and lower gastrointestinal (GI) tracts, coelomic/abdominal cavities and breeding evaluation of avian species. We perform a full range of small mammal dentistry services including occlusal adjustments and trims, extractions and abscess removal procedures. We currently provide emergency services

24 hours a day and are striving to offer appointments 7 days a week. Approximately 40 to 50 cases are seen per week.

Located in Monmouth County, New Jersey, RBVH is one of the premier veterinary hospitals in the country. We are a 24-hour emergency and critical care facility with a referral practice, general practice and house call service that employs more than 80 veterinarians. This includes full-time specialists in acupuncture, behavior, cardiology, clinical nutrition, critical care, dentistry & oral surgery, dermatology & allergy, internal medicine, neurology & neurosurgery, oncology (medical & radiation), ophthalmology, physical rehabilitation, and surgery (orthopedic & soft tissue). Grand rounds are conducted every morning allowing each patient to benefit from the experience and expertise of our staff. We are actively involved in teaching through our externship, internship, specialty internship, and residency programs and we take immense pride in our highly trained and experienced technical and support staff as well as our state-of-the-art facility.

The RBVH Veterinary Healthcare Network includes RBVH Cherry Hill, RBVH Hillsborough and

RBVH Linwood which are all 24-hour emergency and specialty hospitals. Currently, Cherry Hill offers surgery, Hillsborough provides clinical nutrition, internal medicine, oncology and ophthalmology, and surgery and internal medicine are available at Linwood. The RBVH Physical Rehabilitation Center (Red Bank) provides physical rehabilitation, medical boarding, weight management and acupuncture for pets living with a wide variety of medical conditions or recovering from surgical procedures. Complex medical cases may be referred from any of our locations to RBVH in Tinton Falls via a complimentary daily shuttle service.

Monmouth County is located on the beautiful Jersey Shore, just minutes from the beach and an hour from New York City and Philadelphia. We offer an exceptionally generous compensation package.

For more information, contact:
Anthony J. DeCarlo, VMD, CEO at
(732) 687-9966 or Anne Thacher,
Assistant CEO at (908) 902-0620 or
rbvh@mac.com. You may also visit us
online at www.rbvh.net

197 Hance Avenue, Tinton Falls, NJ 07724 • 732.747.3636 • www.rbvh.net

2010 SPONSORS!



Animal Health



2010 ABVP EXHIBITORS & SPONSORS !

We wish to thank our sponsors and exhibitors for their support. Be sure to stop by and visit with them about your needs and to get your Bingo card initialed. * Indicates our sponsors.

AAFP (Booth 20)
800.874.0498
www.catvets.com

AAHA (Booth 1 & 2)
303.986.2800
www.aahanet.org

ABVP (Booth 14)
800.697.3583
www.abvp.com

Abaxis (Booth 15)
800.822.2947
www.abaxis.com

Aesculight Surgical Lasers *
(Booth 17)
352.468.2139
www.aesculight.com

Bayer * (Booth 7 & 8)
816.351.0693
www.bayerdvm.com

Bio Vision Technologies (Booth 40)
303.225.0960
www.biovisiontech.com

Companion Therapy Laser by Litecure
(Booth 9)
302.709.0408
www.companiontherapylaser.com

Covidien (Booth 16)
508.261.8035
www.covidien.com

Dan Scott and Associates (Booth 11)
614.890.0370
www.danscottandassociates.com

Diagnostic Imaging Systems, Inc. (Booth 32)
605.341.2433
www.vetxray.com

DVM Solutions (Booth 21)
866.373.9627
www.dvmsolutions.com

Ellman International, Inc *
(Booth 3)
800.835.5355
www.ellman.com

Elsevier (Booth 26 & 27)
720.935.0811
www.us.elsevierhealth.com

Heska (Booth 37)
800.464.3752
www.heska.com

IDEXX Laboratories * (Booth 6)
207.556.0300
www.idexx.com

MDS Inc. (Booth 29)
800.435.9352
www.mdsincorporated.com

Meds for Vets Pharmacy (Booth 28)
866.MED.4VET
www.medsforvets.com

Merial Limited * (Booth 13)
888.merial.1
www.merial.com

P&G Pet Care (Eukanuba & Iams) * (Booth 10)
800.535.vets
www.pgpetwellness.com

PetRays Telemedicine Consultants
(Booth 31)
888.4.petrays
www.petrays.com

Pfizer * (Booth 38)
713.395.7807
www.pfizerah.com

Purina Care Pet Health Insurance
(Booth 19)
210.471.0471
www.purinacare.com

SCIL Animal Care (Booth 18)
877.724.5838
www.scilvet.com

Sound-Eklin (Booth 23)
800.268.5354
www.soundeklin.com

Universal Ultra Sound (Booth 36)
914.666.6200
www.universalultrasound.com

VetRay Technology by Sedecal (Booth 25)
800.920.9525
www.vetray.com

Wiley-Blackwell (Booth 4 & 5)
800.923.6211
www.wiley.com

EXHIBITOR MAP

