



# **SADDLE UP!**

**AMERICAN BOARD OF VETERINARY PRACTITIONERS  
14TH ANNUAL SYMPOSIUM ★ OMNI AUSTIN HOTEL  
AUSTIN, TEXAS**

**ONSITE  
PROGRAM**





VETERINARY EXCLUSIVE

# *natural products & real results*

FOR ALL ANIMALS



**ABVP SPECIAL**

**SAVE 10%**

\*Valid for first-time orders only. Use code "ABVP09." Offer expires May 11, 2009.

HEALx nutritional supplements and wound healing and skin care topical products have been developed based on **25 years' experience with certified organic principles**. These products were created and tested by veterinarians based on the needs of the animal and use only human quality ingredients.



## Use of HEALx Soother Plus in a Non-healing Wound in a Whippet\*

A whippet presented with a 14-day history of a non-healing, granulating wound while on antibiotic therapy. **Soother Plus®** was applied 3 times daily and used as the exclusive topical medication.



\*Thomas Bankstahl, DVM, Director of Medical and Surgical Services, Parkway Small Animal & Exotic Hospital, Clinton Township, Michigan

To order call your veterinary distributor or call 800-946-4782.



## 2009 ABVP PRACTITIONER'S SYMPOSIUM

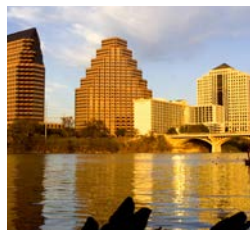

### NAME BADGES

Name badges will be required for participation in all sessions, luncheons and exhibit hall. Badges may be picked up at the registration desk during the hours listed. ABVP appreciates the sponsorship of lanyards by 

### CANCELLATIONS & REFUNDS

Cancellations and refunds are no longer permitted. Should you want to sell your ABVP Annual Dinner or city tour tickets, you can do so by posting them on the bulletin board.

### REGISTRATION DESK HOURS

Wednesday, April 15: 2:00pm – 5:00pm  
 Thursday, April 16: 10:00am – 5:00pm  
 Friday, April 17: 7:00am – 4:00pm  
 Saturday, April 18: 7:00am – 4:00pm  
 Sunday, April 19: 7:30am – 11:30am

### EXHIBITS

Please be sure to visit our sponsors and exhibitors. Through their continued support, we are able to offer quality programs and still keep registration costs down.

Friday, April 17: 12:00pm – 4:30pm  
 Saturday, April 18: 7:30am – 4:30pm  
 Sunday, April 19: 7:30am – 11:00am

### WELCOME RECEPTION

Friday, April 17, 6:30pm – 8:00pm Sponsored by  

### CONTINUING EDUCATION CREDITS

Attendees of the conference can earn 21.0 plus hours of Continuing Education. Certificates are included in your conference materials.

Thursday, April 16: 4.0 hours  
 Friday, April 17: 8.0 hours  
 Saturday, April 18: 6.0 hours  
 Sunday, April 19: 3.0 hours

### ANNUAL SYMPOSIUM DINNER & FUN NIGHT

Saturday, April 18, 7:30pm – 10:00pm. Join your fellow colleagues for a great evening of fun, food and entertainment as we honor our new ABVP Diplomates. The evening will begin at the Omni Austin Hotel with a cocktail reception at 7:00pm and dinner at 7:30pm.

Dinner Sponsored by  Bayer

### DIPLOMATE MEETING

Saturday, April 18, 5:30pm – 6:30pm. All ABVP Diplomates and other interested parties are encouraged to attend this meeting to provide feedback to the Council of Regents. The agenda will cover committee activities and other ABVP business.

### WORKSHOPS

**Item writing:** Friday April 17, 7:30pm – 9:00pm. ABVP Diplomates interested in writing examination questions to earn credits toward recertification must receive training in item writing.

**Certification:** Saturday April 18, 6:00pm – 6:50pm. Attendees considering ABVP certification are invited to participate in this complimentary workshop. Topics include application and case report presentation, study tips, deadlines, fees and examination structure.

### HOTEL MAP Room locations are listed beside the events or below the name of the specialty track.

#### BALLROOM LEVEL SECOND FLOOR



#### LONGHORN ROOM THIRD FLOOR

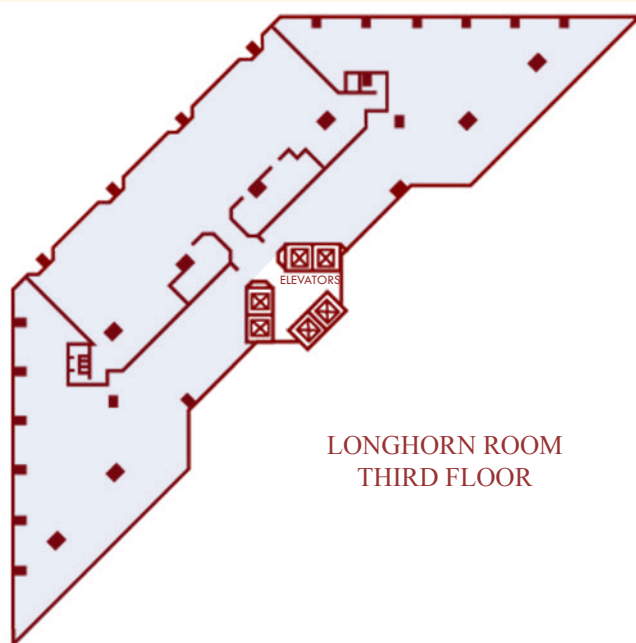



# THE AMERICAN BOARD OF VETERINARY PRACTITIONERS

April 16-19, 2009 ★ Austin, Texas

## THURSDAY - APRIL 16, 2009





1:00pm-5:00pm	<b>CROSS SPECIES:</b> ABVP / AAHA KICK-OFF SEMINAR: ELECTRONIC HEALTH RECORDS AND AAHA STANDARD DIAGNOSTIC TERMS (CAPITAL BALLROOM) Noell Moseley, Heidi Burnett, and Kim Smith					
	<b>AVIAN</b>	<b>BOVINE</b>	<b>CANINE</b>	<b>EQUINE</b>	<b>EXOTIC COMPANION MAMMALS</b> LIBERTY ROOM	<b>FELINE</b>
1:30pm-2:30pm					Cardiovascular Physiology of Small Exotic Mammals Jill Heatley	
2:30pm-3:30pm					Cardiovascular Diseases of Exotic Companion Mammals Jill Heatley	
3:30pm-4:30pm					Cardiovascular Physiology of Small Exotic Mammals and Exam Techniques Jill Heatley	
5:30pm-7:00pm	CITY TOUR Leave from Omni Austin Hotel					

## FRIDAY - APRIL 17, 2009

7:00am-8:00am	SUN RISE SESSION ON PROBIOTICS & GASTROINTESTINAL HEALTH: WHAT'S NEW? AND COMPLIMENTARY CONTINENTAL BREAKFAST (CAPITAL BALLROOM) Jörg Steiner Sponsored by  P&G Pet Care					
8:00am-12:00pm	<b>CROSS SPECIES:</b> ANIMAL WELFARE—A JOURNEY THROUGH HISTORY, CULTURE, SCIENCE AND PROFESSIONAL OBLIGATION AND OTHER HOT TOPICS (CAPITAL BALLROOM) (10 minute break each hour) Gail C. Golab Partially Sponsored by  AVMA					
12:00pm-12:30pm	EXHIBIT HALL OPENING GALA (LONE STAR)					
12:30pm-1:30pm	NETWORKING LUNCHEON (LONGHORN)					
	<b>AVIAN</b> AUSTIN NORTH	<b>SMALL RUMINANT</b> AUSTIN SOUTH	<b>CANINE</b> CAPITAL BALLROOM B	<b>EQUINE</b> EXECUTIVE	<b>EXOTIC COMPANION MAMMALS</b> LIBERTY ROOM	<b>FELINE</b> CAPITAL BALLROOM A
1:30pm-2:30pm	Anatomy of the Psittacine Digestive Tract from Oral Cavity to Cloaca Drury Reavill	New Approach: Parasite control in goats, sheep and camelids - Part I Misty Edmondson	Regional Analgesia for Oral Surgery in Dogs and Cats Brett Beckman Sponsored by  Pfizer	Mare Anatomy and Physiology John Dascanio	Clinical Pathology of Small Exotic Mammals - Part I Jill Heatley	Errors / Omissions in the Laboratory Sally Lester
2:30pm-3:00pm	REFRESHMENT BREAK IN EXHIBIT HALL (LONE STAR)					
3:00pm-4:00pm	Diseases of the Psittacine Digestive Tract from Oral Cavity to Cloaca Drury Reavill	New Approach: Parasite control in goats, sheep and camelids - Part II Misty Edmondson	Noninvasive Oral Fracture Repair Brett Beckman Sponsored by  Pfizer	Stallion Anatomy and Physiology (up to 3:30pm) John Dascanio	Clinical Pathology of Small Exotic Mammals - Part II Jill Heatley	Anemia and Coagulation Sally Lester
4:00pm-4:30pm	REFRESHMENT BREAK IN EXHIBIT HALL (LONE STAR)					
4:30pm-5:30pm	Case Presentations involving the Psittacine Digestive Tract Drury Reavill & Christal Pollock	New Approach: Parasite control in goats, sheep and camelids - Part III Misty Edmondson	Surgical Dental Extractions Brett Beckman Sponsored by  Pfizer	Hormonal Control of Reproduction (up to 6:00pm) John Dascanio	Clinical Pathology of Small Exotic Mammals - Part III Jill Heatley	Common Hematology Interpretation Sally Lester
5:30pm-6:30pm						Leukon Interpretation with Clinical Cases Sally Lester
6:30pm-8:00pm	WELCOME RECEPTION (ATRIUM) - Sponsored by  Pfizer  Animal Health					
7:30pm-9:00pm	ITEM WRITING WORKSHOP (CAPITAL BALLROOM A) Dennis French					



**SATURDAY - APRIL 18, 2009**

	<b>AVIAN</b> AUSTIN NORTH	<b>SMALL RUMINANT</b> AUSTIN SOUTH	<b>CANINE</b> CAPITAL BALLROOM B	<b>EQUINE</b> EXECUTIVE	<b>EXOTIC COMPANION MAMMALS</b> LIBERTY ROOM	<b>FELINE</b> CAPITAL BALLROOM A
7:30am-8:00am	COFFEE IN EXHIBIT HALL (LONE STAR)					
8:00am-9:00am	Anatomy of the Passerine and Ramphastidae Digestive Tract from Oral Cavity to Cloaca <i>Drury Reavill</i>	Selection and Evaluation of Beef Heifers <i>Bob Larson</i>	Managing Chronic & Cancer-Related Oral Pain in Companion Animals <i>Brett Beckman</i> Sponsored by 	Equine Thyroid Dysfunction - Fact or Fiction? <i>Nat Messer</i>	Endocrine System & Diseases of Exotic Companion Mammals - Part I <i>Cathy Johnson-Delaney</i>	Integrating the CBC with Clinical Cases <i>Sally Lester</i>
9:00am-9:30am	REFRESHMENT BREAK IN EXHIBIT HALL (LONE STAR)					
9:30am-10:30am	Diseases of the Passerine and Ramphastidae Digestive Tract from Oral Cavity to Cloaca <i>Drury Reavill</i>	Nutritional Development of Beef Heifers <i>Bob Larson</i>	Veterinary Dental Radiographic Technique Simplified <i>Brett Beckman</i> Sponsored by 	Diagnosis and Treatment of Pituitary Pars Intermedia Dysfunction <i>Nat Messer</i>	Endocrine System & Diseases of Exotic Companion Mammals - Part II <i>Cathy Johnson-Delaney</i>	Common Chemistry Patterns with Application to Cases <i>Sally Lester</i>
10:30am-11:00am	REFRESHMENT BREAK IN EXHIBIT HALL (LONE STAR)					
11:00am-12:00pm	Case Presentations Involving the Passerine Digestive Tract <i>Drury Reavill</i>	Case Studies: Heifer Development and Reproductive Failures <i>Bob Larson</i>	Therapy of Stage II and Stage III Periodontal Disease <i>Brett Beckman</i> Sponsored by 	Equine Metabolic Syndrome: Obesity / Insulin Resistance - Is it a Cause or an Effect? <i>Nat Messer</i>	Endocrine System & Diseases of Exotic Companion Mammals - Part III <i>Cathy Johnson-Delaney</i>	Newer Lab Tests and How to Use Them <i>Sally Lester</i>
12:00pm-12:30pm	REFRESHMENT BREAK IN EXHIBIT HALL (LONE STAR)					
12:30pm-1:30pm	NETWORKING LUNCHEON Sponsored by  IT'S A BIG WORLD OUT THERE: Recent scientific studies involving radio transmitted research on various wild species. (LONGHORN) Speaker: <i>Kevin Fitzgerald</i>					
1:30pm-2:30pm	Anatomy of the Raptor Digestive Tract from Oral Cavity to Cloaca <i>Christal Pollock</i>	BVD Persistent Testicular Infections - Part I <i>Misty Edmondson</i>	Eyelids, Ulcerative Corneal Disease, and Non-Ulcerative Corneal Disease - Part I <i>Phillip Pickett</i>	Endocrinopathic Laminitis - Where does it fit in the Endocrine Puzzle? <i>Nat Messer</i>	Emergency Care of Ferrets <i>Kevin Fitzgerald</i>	Case Integration and Study <i>Sally Lester</i>
2:30pm-3:00pm	REFRESHMENT BREAK IN EXHIBIT HALL (LONE STAR)					
3:00pm-4:00pm	Diseases of the Raptor Digestive Tract from Oral Cavity to Cloaca <i>Christal Pollock</i>	BVD Persistent Testicular Infections - Part II <i>Misty Edmondson</i>	Eyelids, Ulcerative Corneal Disease, and Non-Ulcerative Corneal Disease - Part II <i>Phillip Pickett</i>	Infertility in the Mare (up to 5:00pm) <i>John Dascanio</i>	Emergency Care of House Rabbits <i>Kevin Fitzgerald</i>	What's All the Salt About? Understanding Sodium and Chloride <i>Jennifer Devey</i>
4:00pm-4:30pm	REFRESHMENT BREAK IN EXHIBIT HALL (LONE STAR)					
4:30pm-5:30pm	Case Presentations Involving the Raptor Digestive Tract <i>Drury Reavill &amp; Christal Pollock</i>	BVD Persistent Testicular Infections - Part III <i>Misty Edmondson</i>	Eyelids, Ulcerative Corneal Disease, and Non-Ulcerative Corneal Disease - Part III <i>Phillip Pickett</i>	Monitoring High Risk Pregnancy (from 5:00pm-6:00pm) <i>John Dascanio</i>	Emergency Medicine for Pocket Pets <i>Kevin Fitzgerald</i>	Blood Gases and Acid-Base: Why Do We Care? (up to 6:00pm) <i>Jennifer Devey</i>
5:30pm-6:30pm	DIPLOMATE MEETING (LIBERTY ROOM)					
6:00pm-6:50pm	ABVP CERTIFICATION WORKSHOP (LONGHORN) <i>Dennis French</i>					
7:00pm-7:30pm	RECEPTION (ATRIUM)					
7:30pm-10:00pm	ANNUAL SYMPOSIUM DINNER AND FUN NIGHT Sponsored by  <b>Bayer</b> (CAPITAL BALLROOM) Entertainment: <i>Kevin Fitzgerald</i>					







# THE AMERICAN BOARD OF VETERINARY PRACTITIONERS

April 16-19, 2009 ★ Austin, Texas

## SUNDAY - APRIL 19, 2009

	AVIAN AUSTIN NORTH	SMALL RUMINANT AUSTIN SOUTH	CANINE CAPITAL BALLROOM B	EQUINE EXECUTIVE	EXOTIC COMPANION MAMMALS LIBERTY ROOM	FELINE CAPITAL BALLROOM A
7:30am-8:00am	COFFEE IN EXHIBIT HALL (LONE STAR)					
8:00am-9:00am	Anatomy of the Digestive Tract from Oral Cavity to Cloaca - Miscellaneous Avian Species <i>Christal Pollock</i>	Bovine Reproductive Diseases (Abortion) <i>Bob Larson</i>	Glaucoma, Cataracts, Fundic & Systemic Diseases - Part I <i>Phillip Pickett</i> Partially Sponsored by 	Breeding the Mare with Fresh Cooled and Frozen Semen <i>John Dascanio</i>	Gastrointestinal Physiology and Diseases of Carnivorous Exotic Companion Mammals - Part I <i>Cathy Johnson-Delaney</i>	The Cat and his Elements - Understanding K, Mg, Ca and P <i>Jennifer Devey</i>
9:00am-9:30am	REFRESHMENT BREAK IN EXHIBIT HALL (LONE STAR)					
9:30am-10:30am	Diseases of the Digestive Tract from Oral Cavity to Cloaca - Miscellaneous Avian Species <i>Christal Pollock</i>	Neosporosis, Leptosporosis, and BVD Bovine Reproductive Disease (Infertility) <i>Bob Larson</i>	Glaucoma, Cataracts, Fundic & Systemic Diseases - Part II <i>Phillip Pickett</i>	Advanced Reproductive Technologies <i>John Dascanio</i>	Gastrointestinal Physiology and Diseases of Carnivorous Exotic Companion Mammals - Part II <i>Cathy Johnson-Delaney</i>	Monitoring the Metabolically Deranged <i>Jennifer Devey</i>
10:30am-11:00am	EXHIBIT HALL BREAK (LONE STAR)					
11:00am-12:00pm	Case Presentations Involving the Digestive Tract - Miscellaneous Avian Species <i>Christal Pollock</i>	Trichomoniasis and Vibrio Biosecurity to Control Reproductive Disease <i>Bob Larson</i>	Glaucoma, Cataracts, Fundic & Systemic Diseases - Part III <i>Phillip Pickett</i>	The Unwanted Horse - Historical Perspectives and Potential Solutions <i>Nat Messer</i>	Gastrointestinal Physiology and Diseases of Carnivorous Exotic Companion Mammals - Part III <i>Cathy Johnson-Delaney</i>	Treating the Metabolically Deranged - Case Studies (up to 12:30pm) <i>Jennifer Devey</i>



### JOIN KEVIN FITZGERALD FOR THE ANNUAL SYMPOSIUM DINNER AND FUN NIGHT

It is with great pleasure that we announce Dr. Kevin Fitzgerald, PhD, DVM, DABVP - Canine and Feline as our evening entertainment for the Annual Symposium Dinner

and Fun Night on April 18.

As a performer, Kevin has opened for such diverse and legendary performers as Bob Hope, Diana Ross, The Temptations, and The Neville Brothers. Despite maintaining a busy practice at Alameda East Veterinary Hospital in Denver, Kevin performs to rave reviews at nearly one hundred corporate and fundraising events annually and is in very high demand as a host, guest speaker and lecturer at universities and veterinary conferences across the country. He believes that laughter is an incredibly important part of everyday life and that nobody could ever laugh too much.

Kevin Fitzgerald graduated with a PhD in Endocrinology from the University of Colorado in 1978. He earned his DVM from the Colorado State University College of Veterinary Medicine in 1983. He is also a Diplomate of the American Board of Veterinary Practitioners, certified in Canine and Feline Practice.



## Save the Date April 15-18, 2010

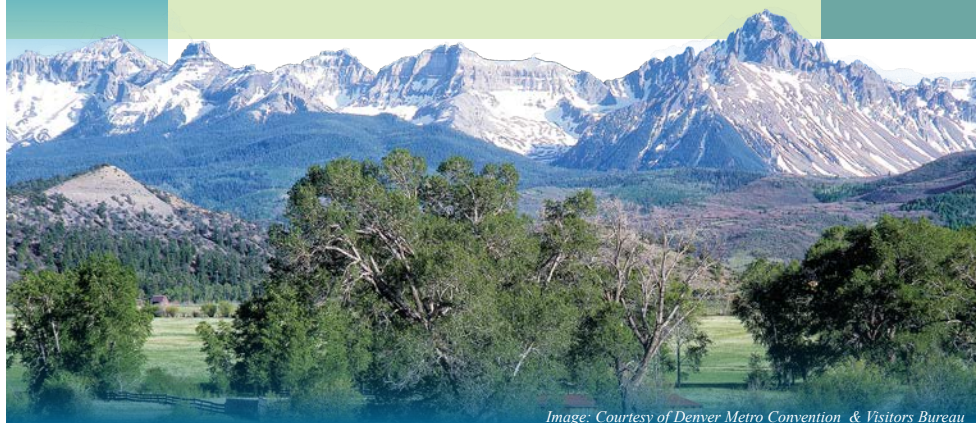

Image: Courtesy of Denver Metro Convention & Visitors Bureau

## 15th Annual ABVP Symposium Denver, Colorado



## LECTURE DESCRIPTIONS

### THURSDAY, APRIL 16

#### EXOTIC COMPANION MAMMAL

1:30pm – 2:30pm ..... Jill Heatley  
**Cardiovascular Physiology of Small Exotic Mammals**

Ferrets, rabbits, rodents, hedgehogs, sugar gliders, skunks, woodchucks and opossums will be reviewed.

2:30pm – 3:30pm ..... Jill Heatley  
**Cardiovascular Diseases of Exotic Companion Mammals**

Common cardiovascular diseases based on the species will also be overviewed.

3:30pm – 4:30pm ..... Jill Heatley  
**Cardiovascular Physiology of Small Exotic Mammals and Exam Techniques**

Physical exam techniques as well as additional diagnostics and treatment options will be given.

### FRIDAY, APRIL 17

7:00am – 8:00am ..... Jörg Steiner  
**Probiotics & Gastrointestinal Health: What's new? During Complimentary Continental Breakfast**  
- Sponsored by **P&G Pet Care**

New findings indicate that the enteric bacterial ecosystem of dogs and cats plays a pivotal role in healthy digestion, but also in many physiological functions outside the gastrointestinal tract. Probiotics can help restore bacterial balance. When ingested in food or as a dietary supplement, these live beneficial bacteria colonize the large intestine. This session will show how these probiotic organisms work to inhibit pathogenic bacteria and restore the bacterial balance for better digestive health.

#### CROSS SPECIES PARTIALLY SPONSORED BY



8:00am – 12:00pm ..... Gail Golab  
**Animal Welfare—A Journey Through History, Culture, Science and Professional Obligation and Other Hot Topics**

Contrasting approaches to animal welfare taken by individuals and groups will be discussed using case studies. Attendees will be encouraged to consider how different groups conceptualize animal welfare, and attempt to bring about or resist changes in approaches to animal use and care. The AVMA's developing strategy of using science-based policy and cooperative engagement will be discussed in light of increasingly complex and polarized animal welfare issues.

### AVIAN

1:30pm – 2:30pm ..... Drury Reavill  
**Anatomy of the Psittacine Digestive Tract from Oral Cavity to Cloaca**

Lectures will focus on the digestive tract of avian species. We will include the oral cavity, esophagus, crop, gastric sections, intestines, and cloaca as well

as the liver and pancreas. The lectures will be divided into different avian groups. After each anatomy and disease session, case presentations will review the concepts from a clinical perspective.

3:00pm – 4:00pm ..... Drury Reavill  
**Diseases of the Psittacine Digestive Tract from Oral Cavity to Cloaca**

4:30pm – 5:30pm ..... Drury Reavill & Christal Pollock

**Case Presentations Involving the Psittacine Digestive Tract**

#### SMALL RUMINANT

1:30pm – 2:30pm ..... Misty Edmondson  
**New Approach: Parasite control in goats, sheep and camelids - Part I**

This will include a discussion of parasite control, urolithiasis, interesting cases & other research findings. This will include goats, sheep, and camelids.

3:00pm – 4:00pm ..... Misty Edmondson  
**New Approach: Parasite control in goats, sheep and camelids - Part II**

4:30pm – 5:30pm ..... Misty Edmondson  
**New Approach: Parasite control in goats, sheep and camelids - Part III**

#### CANINE LECTURES OF BRETT BECKMAN SPONSORED BY



1:30pm – 2:30pm ..... Brett Beckman  
**Regional Analgesia for Oral Surgery in Dogs & Cats**  
Utilization of regional nerve blocks for oral surgery in dogs and cats. Pain relief is synonymous with quality patient care. This lecture details techniques that can be incorporated into the companion animal hospital dentistry service to maximize safety, care and comfort for patients undergoing oral surgical procedures. This discussion also suggests adopting regions blocked rather than the traditional confusing nomenclature.

3:00pm – 4:00pm ..... Brett Beckman  
**Noninvasive Oral Fracture Repair**  
Oral fracture repair in dogs and cats has traditionally taken many different forms. Pins, plates, screws and external coaptation devices are all methods previously employed that are relatively invasive. Small dogs, cats and immature animals have very little bone volume to support the more invasive devices, often resulting in failure. Noninvasive methods employing the teeth and using interdental wiring, orthodontic devices, composite and acrylic can bypass traditional invasive methods, decreasing procedure time and ensuring a comfortable occlusion.

4:30pm – 5:30pm ..... Brett Beckman  
**Surgical Dental Extractions**  
Teeth that require extraction in dogs and cats may not necessarily have periodontal involvement where bone has been destroyed, thus facilitating extraction. Fractured and discolored teeth may have no bone

compromise, making extraction difficult without proper oral surgical skills. This lecture discusses indications, tricks and tips, landmarks, theory and step-by-step instructions for surgical extractions in dogs and cats.

#### EQUINE

1:30pm – 2:30pm ..... John J. Dascanio  
**Mare Anatomy and Physiology**

Overall, there will be seven hours of mare reproduction topics including mare and stallion anatomy and physiology, reproductive hormones, mare infertility, monitoring the high-risk pregnant mare and breeding with fresh cooled and frozen semen. Interaction with participants will be encouraged and lectures presented with a practical application.

3:00pm – 3:30pm ..... John J. Dascanio  
**Stallion Anatomy and Physiology**

4:30pm – 6:00pm ..... John J. Dascanio  
**Hormonal Control of Reproduction**

#### EXOTIC COMPANION MAMMAL

1:30pm – 2:30pm ..... Jill Heatley  
**Clinical Pathology of Small Exotic Mammals - Part I**  
Especially as it differs from canine and feline will be reviewed. After lecture, participants should have a firm grasp of physiologic differences of these species as they relate to clinical pathology. Common diseases that may be diagnosed with clinical pathology will be reviewed for ferrets, rabbits, rodents and other small exotic mammals.

3:00pm – 4:00pm ..... Jill Heatley  
**Clinical Pathology of Small Exotic Mammals - Part II**

4:30pm – 5:30pm ..... Jill Heatley  
**Clinical Pathology of Small Exotic Mammals - Part III**

#### FELINE

1:30pm – 2:30pm ..... Sally Lester  
**Errors / Omissions in the Laboratory**  
Lectures are aimed at improving diagnostic acumen and challenging all of us to think not about numbers, but where they come from and how they are generated. The lectures will deal with different aspects of clinical pathology, including hematology, coagulation, and chemistry and will attach the numbers to cases and encourage discussion of the clinical aspects. Pathophysiology is an important part of improving diagnostic acumen and will be included with the lectures.

3:00pm – 4:00pm ..... Sally Lester  
**Anemia and Coagulation**

4:30pm – 5:30pm ..... Sally Lester  
**Common Hematology Interpretation**

5:30pm – 6:30pm ..... Sally Lester  
**Leukon Interpretation with Clinical Cases**







# THE AMERICAN BOARD OF VETERINARY PRACTITIONERS

April 16-19, 2009 ★ Austin, Texas

## LECTURE DESCRIPTIONS

### SATURDAY, APRIL 18

#### AVIAN

8:00am – 9:00am .....Drury Reavill  
**Anatomy of the Passerine and Ramphastidae Digestive Tract from Oral Cavity to Cloaca**  
See Friday 1:30pm for Description.

9:30am – 10:30am .....Drury Reavill  
**Diseases of the Passerine and Ramphastidae Digestive Tract from Oral Cavity to Cloaca**

11:00am – 12:00pm .....Drury Reavill  
**Case Presentations Involving the Passerine Digestive Tract**

1:30pm – 2:30pm .....Christal Pollock  
**Anatomy of the Raptor Digestive Tract from Oral Cavity to Cloaca**

Lectures will cover the gastrointestinal system of the raptor as well as miscellaneous species including ramphastids, waterfowl and galliforms, columbiforms, aquatic birds, and ratites. Lectures will first cover normal anatomy and physiology, followed by a discussion of the diseases of the gastrointestinal tract beginning in the oropharynx and ending with the cloaca.

3:00pm – 4:00pm .....Christal Pollock  
**Diseases of the Raptor Digestive Tract from Oral Cavity to Cloaca**

4:30pm – 5:30pm ..... Drury Reavill & Christal Pollock  
**Case Presentations Involving the Raptor Digestive Tract**

#### BOVINE

8:00am – 9:00am ..... Bob Larson  
**Selection and Evaluation of Beef Heifers**  
Three presentations that provide an overview on how to incorporate heifer development into cow-calf practice to benefit both the practitioner and client.

9:30am – 10:30am ..... Bob Larson  
**Nutritional Development of Beef Heifers**

11:00am – 12:00pm ..... Bob Larson  
**Case Studies: Heifer Development and Reproductive Failures**

1:30pm – 2:30pm ..... Misty Edmondson  
**BVD Persistent Testicular Infections - Part I**  
Discussion will include pathogenesis of testicular infections, the significance of infection, and more.

3:00pm – 4:00pm ..... Misty Edmondson  
**BVD Persistent Testicular Infections - Part II**

4:30pm – 5:30pm ..... Misty Edmondson  
**BVD Persistent Testicular Infections - Part III**

#### CANINE

LECTURES OF BRETT BECKMAN SPONSORED BY 

8:00am – 9:00am .....Brett Beckman  
**Managing Chronic and Cancer-Related Oral Pain in Dogs and Cats**

Chronic and cancer-related oral pain in companion animals requires diligence for appropriate management. Continuous rate infusions can be utilized to minimize the central sensitization and peripheral pain mechanisms. Case management examples are discussed with an emphasis on the utilization of specific agents used to treat the specific mechanisms involved with chronic and cancer pain.

9:30am – 10:30am .....Brett Beckman  
**Veterinary Dental Radiography Technique Simplified**  
Veterinary dental radiography has traditionally been difficult to learn and master. The bisecting angle technique is a difficult one to conceptualize for many. However, veterinary dental radiography need not be cumbersome if a few basic guidelines are followed to simplify the bisecting angle dilemma. This simplified approach should greatly decrease the confusion and help participants avoid commonly encountered pitfalls.

11:00am – 12:00pm .....Brett Beckman  
**Therapy of Stage II & Stage III Periodontal Disease**  
Some confusion exists with treatment options available to treat Stage II and III periodontal lesions. Closed and open root planing, root surface biomodification, bone graft particulates and follow-up care are discussed to outline proper therapy of this aspect of periodontal disease.

1:30pm – 2:30pm .....J. Phillip Pickett  
**Eyelids, Ulcerative Corneal Disease, and Non-Ulcerative Corneal Disease - Part I**

These three lecture hours will be devoted to common eyelid, ulcerative and non-ulcerative corneal diseases with emphasis on new medical and surgical innovations.

3:00pm – 4:00pm .....J. Phillip Pickett  
**Eyelids, Ulcerative Corneal Disease, and Non-Ulcerative Corneal Disease - Part II**

4:30pm – 5:30pm .....J. Phillip Pickett  
**Eyelids, Ulcerative Corneal Disease, and Non-Ulcerative Corneal Disease - Part III**

#### EQUINE

8:00am – 9:00am .....Nat Messer  
**Equine Thyroid Dysfunction - Fact or Fiction?**

Considerable controversy surrounds the diagnosis of hypothyroidism in horses. Clinical signs attributed to hypothyroidism in horses are non specific and seldom appear in thyroidectomized horses. This presentation will address the significance of low thyroid hormone levels in horses and outline a diagnostic approach for evaluation of thyroid function in the horse.

9:30am – 10:30am .....Nat Messer  
**Diagnosis and Treatment of Pituitary Pars Intermedia Dysfunction**

The diagnosis and treatment of pituitary dysfunction is frequently misunderstood and incorrectly applied due to several conflicting reports that have appeared in the veterinary literature. This presentation analyzes these various reports to determine which is most likely to provide you with accurate results.

11:00am – 12:00pm .....Nat Messer  
**Equine Metabolic Syndrome: Obesity/Insulin Resistance - Is it a Cause or an Effect?**

The causes and effects of obesity in horses are complex and incompletely understood. This presentation will look at both the known and proposed causes and effects of this ever increasing problem seen in horses and provide potential explanations as well as consequences.

1:30pm – 2:30pm .....Nat Messer  
**Endocrinopathic Laminitis - Where does it Fit in the Endocrine Puzzle?**

Many cases of chronic laminitis develop for reasons other than the more well-recognized inciting causes of acute laminitis. These cases of chronic laminitis seem to occur in older horses that are frequently obese and for no other apparent reason. This presentation will offer some potential explanations based on what we have learned about the equine endocrine puzzle.

3:00pm – 5:00pm ..... John J. Dascanio  
**Infertility in the Mare**  
See Friday 1:30pm for Description.

5:00pm – 6:00pm ..... John J. Dascanio  
**Monitoring High Risk Pregnancy**

#### EXOTIC COMPANION MAMMAL

8:00am – 9:00am ..... Cathy Johnson-Delaney  
**Endocrine System and Diseases of Exotic Companion Mammals - Part I**

The anatomy and physiology and pathophysiology of endocrine diseases of rabbits, ferrets, guinea pigs, chinchillas, small rodents, hedgehogs and sugar gliders. Diagnostic testing including histopathology and hormonal assays along with treatment regimens including diet, pharmaceuticals, surgery and husbandry vary depending on the species, disease, age and sex of the pet.

9:30am – 10:30am ..... Cathy Johnson-Delaney  
**Endocrine System and Diseases of Exotic Companion Mammals - Part II**

11:00am – 12:00pm ..... Cathy Johnson-Delaney  
**Endocrine System and Diseases of Exotic Companion Mammals - Part III**



## LECTURE DESCRIPTIONS

1:30pm – 2:30pm ..... Kevin Fitzgerald  
**Emergency Care of Ferrets**  
Current concepts in urgent care for ferrets will be reviewed.

3:00pm – 4:00pm ..... Kevin Fitzgerald  
**Emergency Care of House Rabbits**  
Advances in the emergency care of house rabbits will be examined.

4:30pm – 5:30pm ..... Kevin Fitzgerald  
**Emergency Medicine for Pocket Pets**  
This session will focus on popular pocket pets and their emergency treatment.

## FELINE

8:00am – 9:00am ..... Sally Lester  
**Integrating the CBC with Clinical Cases**  
Lectures are aimed at improving diagnostic acumen and challenging all of us to think not about numbers but where they come from and how they are generated. The lectures will deal with different aspects of clinical pathology, including hematology, coagulation, and chemistry and will attach the numbers to cases and encourage discussion of the clinical aspects. Pathophysiology is an important part of improving diagnostic acumen and will be included with the lectures.

9:30am – 10:30am ..... Sally Lester  
**Common Chemistry Patterns with Application to Cases**

11:00am – 12:00pm ..... Sally Lester  
**Newer Lab Tests and How to Use Them**

1:30pm – 2:30pm ..... Sally Lester  
**Case Integration and Study**

3:00pm – 4:00pm ..... Jennifer Devey

### What's all the Salt About? Understanding Sodium and Chloride

Understanding what Sodium and Chloride numbers mean on a laboratory printout can help in the understanding of disease processes and ensure clinicians make appropriate fluid choices. The emphasis of this lecture will be on clinical applications.

4:30pm – 6:00pm ..... Jennifer Devey  
**Blood Gases and Acid Base: Why do we Care?**  
Blood gases provide a window into understanding the metabolic and ventilatory state of the cat. This session will focus on how to apply results of blood gases to assessment of the disease process as well as formulating treatment plans.

## SUNDAY, APRIL 19

## AVIAN

8:00am – 9:00am ..... Christal Pollock  
**Anatomy of the Digestive Tract from Oral Cavity to Cloaca – Miscellaneous Avian Species**

9:30am – 10:30am ..... Christal Pollock  
**Diseases of the Digestive Tract from Oral Cavity to Cloaca – Miscellaneous Avian Species**

11:00am – 12:00pm ..... Christal Pollock  
**Case Presentations Involving the Digestive Tract – Miscellaneous Avian Species**  
See Saturday 1:30pm for Description.

## BOVINE

8:00am – 9:00am ..... Bob Larson  
**Bovine Reproductive Disease (Abortion)**  
These three presentations will review abortion and infertility causing pathogens in beef cattle herds and their control.

9:30am – 10:30am ..... Bob Larson  
**Neosporosis, Leptospirosis, and BVD Bovine Reproductive Disease (Infertility)**

11:00am – 12:00pm ..... Bob Larson  
**Trichomoniasis and Vibrio Biosecurity to Control Reproductive Disease**

## CANINE

LECTURES OF J. PHILLIP PICKETT PARTIALLY SPONSORED BY



8:00am – 9:00am ..... J. Phillip Pickett  
**Glaucoma, Cataracts, Fundic & Systemic Diseases – Part I**

These three lecture hours will be devoted to discussion of glaucoma, cataracts and diseases of the posterior segment. Emphasis will be placed on practical medical management with information concerning innovations available through referral centers. Ophthalmic manifestations of systemic diseases in dogs will be discussed as well.

9:30am – 10:30am ..... J. Phillip Pickett  
**Glaucoma, Cataracts, Fundic & Systemic Diseases – Part II**

11:00am – 12:00pm ..... J. Phillip Pickett  
**Glaucoma, Cataracts, Fundic & Systemic Diseases – Part III**

## EQUINE

8:00am – 9:00am ..... John J. Dascanio  
**Breeding the Mare with Fresh Cooled and Frozen Semen**  
See Friday 1:30pm for Description.

9:30am – 10:30am ..... John J. Dascanio  
**Advanced Reproductive Technologies**

11:00am – 12:00pm ..... Nat Messer  
**The Unwanted Horse – Historical Perspectives and Potential Solutions**

The current plight of the unwanted horse in the United States has been directly impacted by various recent state legislative actions. The legislation was most likely intended to be in the horse's best interests, but

it has brought about unintended consequences that now appear to be having a negative impact on the welfare of these horses. As we address the plight of unwanted horses, it is particularly important to reflect on the past so as to avoid similar ill-fated legislative efforts in the future.

## EXOTIC COMPANION MAMMAL

8:00am – 9:00am ..... Cathy Johnson-Delaney  
**Gastrointestinal Physiology and Diseases of Carnivorous Exotic Companion Mammals – Part I**  
The complex anatomy, physiology and disease syndromes of the ferret will be emphasized. Diagnostic testing and therapeutic options including diet and psychological effects will be covered. Hedgehogs and sugar gliders have gastrointestinal systems and diseases similar to carnivores and will be included.

9:30am – 10:30am ..... Cathy Johnson-Delaney  
**Gastrointestinal Physiology and Diseases of Carnivorous Exotic Companion Mammals – Part II**

11:00am – 12:00pm ..... Cathy Johnson-Delaney  
**Gastrointestinal Physiology and Diseases of Carnivorous Exotic Companion Mammals – Part III**

## FELINE

8:00am – 9:00am ..... Jennifer Devey  
**The Cat and His Elements – Understanding K, Mg, Ca and P**

Many diseases can be associated with abnormalities of potassium, magnesium, calcium and phosphorus. This session will discuss these electrolytes from an applied physiology and pathophysiology perspective with the goal of improving understanding of what abnormal results mean clinically to the cat.

9:30am – 10:30am ..... Jennifer Devey  
**Monitoring the Metabolically Deranged**

Monitoring always starts with the patient and a good physical examination no matter what the blood tests indicate, but test results can help guide the type and frequency of monitoring. This session will focus on practical monitoring of the cat with significant metabolic abnormalities.

11:00am – 12:30pm ..... Jennifer Devey  
**Treating the Metabolically Deranged – Case Studies**

Injured or ill cats with significant metabolic abnormalities can be challenging to treat. As a general rule, patients should be treated using case studies, not numbers. This session will focus on how to apply abnormal laboratory results to formulate effective treatment plans with the goal of getting the cat home as quickly as possible.







## SPEAKER BIOS

### **Brett Beckman, DVM, FAVD, DAVDC, DAAPM**

Dr. Beckman is a 1987 graduate of Mississippi State University and is acting President of the American Veterinary Dental Society. He holds certifications as Fellow in the Academy of Veterinary Dentistry, Diplomate in the American Veterinary Dental College and a Diplomate in the American Academy of Pain Management. He has published numerous peer-reviewed articles in the field of veterinary dentistry, oral surgery and pain management. Dr. Beckman was honored as Alumnus of the Year by the Mississippi State University College of Veterinary Medicine in 2007. He owns and operates the Veterinary Dental Education Center in Punta Gorda, Florida.

### **Heidi Burnett, DVM, DABVP-Canine and Feline**

Dr. Burnett graduated from Cornell University with high honors in Neurobiology and Animal Behavior. She obtained her Veterinary degree from the University of Florida in 1990 and became a Diplomate of the American Board of Veterinary Practitioners-Canine and Feline Practice. She has recently completed two terms on the American Animal Hospital Association's Board of Directors and currently chairs the Electronic Health Records Task Force and Diagnostic Codes Review Board. Dr. Burnett's special interests include complex internal medicine cases, dermatology, feline medicine and behavior. Her husband, Craig, owns a web site development company and was also a veterinarian and practice management consultant.

### **John Dascanio, VMD, DACT, DABVP-Equine**

Dr. Dascanio is an associate professor of Theriogenology and Equine Field Services in the Department of Large Animal Clinical Sciences at the Virginia-Maryland College of Veterinary Medicine. He earned his V.M.D. from the University of Pennsylvania in 1988 and completed his residency and internship at Cornell University in 1991. Prior to joining the faculty at Virginia Tech in 1993, he was an assistant professor at Oregon State University. Dr. Dascanio's research interests are in the field of equine reproduction. His other main research focus is the use of information technology to enhance veterinary education. He is board certified as a Diplomate of the American College of Theriogenologists and the American Board of Veterinary Practitioners-Equine Practice.

### **Jennifer Devey, DVM, DACVECC**

Dr. Devey is a 1988 graduate of the Ontario Veterinary College, University of Guelph. She completed an internship and residency at the Animal Emergency Center in Milwaukee, WI, and became a Diplomate of the American College of Veterinary Emergency and Critical Care in 1996. She subsequently completed a surgical residency studying at private practices in the USA. Dr. Devey has been director of emergency and intensive care services at a number of large private referral practices in Canada and the United States. She has published over 50 articles and book chapters, is actively involved in research, and delivered over 350 lectures and scientific presentations worldwide.

### **Misty Edmondson, DVM, MS, DACT**

Dr. Edmondson is a native of Elmore County, Alabama. She received a B.S. in microbiology in 1997 and D.V.M. in 2001 from Auburn University. After practicing for two years in mixed animal practice, Dr. Edmondson returned to Auburn University where she completed a residency in food animal theriogenology and M.S. in biomedical sciences. She is a Diplomate of the American College of Theriogenologists. Dr. Edmondson is currently an assistant professor in the food animal section at Auburn University's College of Veterinary Medicine. Her interests are beef cattle and small ruminants with a focus on infectious causes of infertility and urogenital surgery.

### **Kevin Fitzgerald, PhD, DVM, DABVP-Canine and Feline**

See page 6.

### **Gail Golab, PhD, DVM, MACVSc**

Dr. Golab earned her Ph.D. from Texas A&M University and her DVM from the University of Illinois. After completing a medical and surgical internship, and following three years in private practice, she accepted a position with the American Veterinary Medical Association as a scientific editor for the Journal of the American Veterinary Medical Association and the American Journal of Veterinary Research. In 1998, Dr. Golab joined the AVMA's Division of Education and Research, serving as staff consultant for issues related to human-animal interactions. In 2001, she became assistant director of the Association's Communications Division. In 2006, Dr. Golab became associate director of the AVMA's newly created Animal Welfare Division and, in 2007, was named its director.

### **J. Jill Heatley, DVM, MS, DABVP-Avian**

Dr. Heatley received her DVM from Texas A&M University in 1995. After three years of private small animal and emergency practice, she completed an internship and residency in Zoological Medicine at Louisiana State University. She also completed her M.Sc. in Veterinary Clinical Sciences in 2002 at Louisiana State University and became a Diplomate of the American Board of Veterinary Practitioners - Avian Practice in the same year. She was staff veterinarian for the Southeastern Raptor Center from 2002-2006 at Auburn University. She became a Diplomate of the American College of Zoological Medicine in 2008, and is currently Clinical Associate Professor of Zoological Medicine at Texas A&M University.

### **Cathy Johnson-Delaney, DVM, DABVP-Avian**

Dr. Johnson-Delaney is a 1980 graduate of Washington State University. She received her ABVP Diplomate status in Avian Practice in 2000. She has served as President of the Association of Avian Veterinarians and is currently the President of the Association of Exotic Mammal Veterinarians. She was awarded Exotic D.V.M. of the year in 2003. Dr. Johnson-Delaney is a frequent author and lecturer in many areas of exotic pet medicine. She also serves as the Medical Director for the Washington Ferret Rescue & Shelter, Veterinarian for the Oregon Tiger Sanctuary in Medford, OR, and as a consulting veterinarian for the Pacific Primate Sanctuary on Maui.



## **SPEAKER BIOS**

### **Bob Larson, DVM, PhD, DACT, DACAN, DACVPM-Epidemiology**

Dr. Larson received his veterinary medical degree from Kansas State University in 1987 and his Ph.D. in 1992. Dr. Larson then spent four years in private practice, primarily in Abilene, Kansas, where he consulted with cow-calf producers and backgrounding/stocker operations. In 1996, he joined the Commercial Agriculture Beef Focus Team at the University of Missouri and was the director of Veterinary Continuing Education at MU until 2006. In 2006, he returned to Kansas State University as the Coleman Chair of Food Animal Production Medicine. He is board certified by the American College of Theriogenologists and the American College of Veterinary Preventive Medicine – Epidemiology Specialty.

### **Sally Lester, DVM, MVSc, DACVP-Clinical & Anatomic Pathology**

Dr. Lester graduated from the Washington State University College of Veterinary Medicine in 1967. After spending 10 years in small animal private practice, she attended the Western College of Veterinary Medicine, earning a Masters in Veterinary Science. In 1982, Dr. Lester founded the first private veterinary diagnostic laboratory in North America to achieve ISO 17025 certification, where she served as CEO until 2006. Dr. Lester is a Diplomate of the American College of Veterinary Pathology, certified in both Clinical Pathology (1980) and Anatomic Pathology (1989). Her current focus is as a private consultant.

### **Nat Messer, DVM, DABVP-Equine**

Dr. Messer is a 1971 graduate of Colorado State University - College of Veterinary Medicine and Biomedical Sciences. He is currently a Professor of Equine Medicine and Surgery at the University of Missouri College of Veterinary Medicine. He is a Diplomate of the American Board of Veterinary Practitioners - Equine Practice. He is an active member of the American Association of Equine Practitioners, serving on the Board of Directors from 1996-1999. He is currently Chair of the AAEP Equine Insurance Committee and represents AAEP on the AVMA Welfare Committee and Unwanted Horse Coalition of the American Horse Council. In 2001, he received the Distinguished Service Award from the AAEP.

### **G. Noell Moseley, DVM, DABVP-Canine and Feline**

Dr. Moseley graduated from the Auburn University College of Veterinary Medicine in 1971. He helped found Hickory Ridge Animal Hospital in 1974, and is one of the founders of Southwind Animal Hospital. Dr. Moseley is a Diplomate of the American Board of Veterinary Practitioners certified in Canine and Feline Practice. He is also a member of the Electronic Health Records Task Force, Diagnostic Codes Review Committee, and Leadership Identification Committee for the American Animal Hospital Association. Dr. Moseley's areas of special interest in practice include neurology, ultrasound and internal medicine.

### **J. Phillip Pickett, DVM, DACVO**

Dr. Pickett is a professor of ophthalmology in the Department of Small Animal Clinical Sciences in the Virginia-Maryland Regional

College of Veterinary Medicine at Virginia Tech. He received his D.V.M. in 1980 from Louisiana State University and completed a residency in veterinary ophthalmology in 1986 at the University of Wisconsin-Madison. Prior to joining the faculty of the college as an assistant professor in 1988, Pickett was a clinical assistant professor at the University of Wisconsin. Pickett's clinical and research interests include genetic eye disease, glaucoma, equine corneal disease, and equine uveitis. He is board certified by the American College of Veterinary Ophthalmologists.

### **Christal Pollock, DVM, DABVP-Avian**

Dr. Pollock is a graduate of the Ohio State University College of Veterinary Medicine. She completed a residency in avian and zoological medicine at the University of Tennessee and is a Diplomate of the American Board of Veterinary Practitioners, certified in Avian Practice. Dr. Pollock served as an assistant professor at the Kansas State University College of Veterinary Medicine and she currently serves as a veterinary consultant for the Lafeber Company and developer of the new web site, LafeberVet.com.

### **Drury Reavill, DVM, DACVP, DABVP-Avian**

Dr. Reavill has over 19 years of experience in avian and exotic clinical practice, laboratory diagnostics and pathology. She graduated from Colorado State University's College of Veterinary Medicine in 1986, and practiced at the Avian Medical Center of Sacramento. She completed her residency in anatomic pathology and gained board certification from American College of Veterinary Pathology in 2000. Dr. Reavill is also a Diplomate of the American Board of Veterinary Practitioners - Avian Practice. She has authored or coauthored over 30 papers, 10 book chapters, one book, and a CD, each covering a wide range of exotic animal disease conditions.

### **Kimberly Smith, MS-Health Informatics**

Kimberly Smith is a Ph.D. candidate in Health Informatics at the University of Texas Health Science Center. She graduated in 1981 from Eastern Kentucky University with a B.S. in microbiology, and earned an M.S. in Health Informatics in 2005 from the University of Texas Health, where she is now a Ph.D. candidate. She is also a medical technologist, and has worked in the laboratory of M.D. Anderson Cancer Center's veterinary medicine division.

### **Jörg M. Steiner, Dr.med.vet., PhD, DACVIM, DECVIM-CA**

Dr. Steiner received both his veterinary degree (1992) and Dr.med. vet. degree (1996) from the Ludwig-Maximilians University in Munich, Germany. He also completed an internship in small animal medicine and surgery at the University of Pennsylvania and a residency in small animal internal medicine at Purdue University. In 1996 he achieved board certification with the American College of Veterinary Internal Medicine and the European College of Veterinary Internal Medicine. In 2000, Dr. Steiner received a Ph.D. from Texas A&M University, where he currently serves as associate professor and director of the GI Laboratory.





# 2009 ABVP EXHIBITORS / SPONSORS!

We wish to thank our sponsors and exhibitors for their support. Be sure to stop by and visit with them about your needs and to get your Bingo card initialed.

## **Abaxis (Booth 21 & 22)**

Phone: 510.675.6500  
www.abaxis.com

## **American Board of Veterinary Practitioners (ABVP) (Booth 28)**

Phone: 800.697.3583  
www.abvp.com

## **American Animal Hospital Association (AAHA) (Booth 18 & 19)**

Phone: 303.986.2800  
www.aahanet.org

## **Aloka Ultrasound (Booth 23)**

Phone: 203.269.5088  
www.alokavet.com

## **Banfield, The Pet Hospital (Booth 4)**

Phone: 503.922.5157  
www.banfield.net

## **\*Bayer Animal Health (Booth 11 & 12)**

Phone: 816.351.0693  
www.bayerdvm.com or www.bayer-ah.com

## **Companion Therapy Laser (Booth 20)**

Phone: 302.709.0408  
www.companiontherapylaser.com

## **Covidien (Booth 27)**

Phone: 800.962.9888 Option 4  
www.covidien.com

## **\*Dan Scott and Associates (Booth 16)**

Phone: 614.890.0370  
www.danscottandassociates.com

## **DVM Resources (Booth 1)**

Phone: 210.499.4533  
www.dvmresources.com

## **DVM Solutions (Booth 5)**

Phone: 210.499.4533  
www.dvmsolutions.com

## **Eklin Medical Systems (Booth 2 & 3)**

Phone: 408.492.0057  
www.eklin.com

## **Elsevier (Booth 34 & 35)**

Phone: 210.497.3198  
www.gdixon.com

## **Hill's Pet Nutrition (Booth 6 & 7)**

Phone: 830.377.3216  
www.hillspet.com

## **IDEXX Laboratories (Booth 33)**

Phone: 800.548.6733  
www.idexx.com

## **International Veterinary Academy of Pain Management (IVAPM) (Booth 17)**

Phone: 615.522.5276  
www.ivapm.org

## **Karl Storz Veterinary Endoscopy (Booth 30)**

Phone: 800.955.7832  
www.karlstorzvet.com

## **MDS-Mobile Data Software (Booth 36)**

Phone: 800.435.9352  
www.mdsvetinfo.com

## **Medical Diagnostic Services (MDS) (Booth 26)**

Phone: 800.435.9352  
www.mdsvet.com

## **\*Merial (Booth 15)**

Phone: 888.merial1 or 888.637.4251  
www.merial.com or www.usmerial.com

## **Natura Pet Products (Booth 24 & 25)**

Phone: 800.532.7261  
www.naturapet.com or www.naturavet.com

## **\*P&G Pet Care (Booth 14)**

Phone: 800-535-VETS or 800.535.8387  
www.PGpetwellness.com

## **\*PetRays Telemedicine Consultants (Booth 13)**

Phone: 888.4petrays or 281.465.0008  
www.petrays.com

## **Petsleeves (Booth 29)**

Phone: 915.342.8755  
www.petsleeves.com

## **\*Pfizer Animal Health (Booth 32)**

Phone: 800.733.5500  
www.pfizerah.com

## **Universal Surgical Instruments (Booth 31)**

Phone: 877.587.6278  
www.universalsurgical.com

## **Universal Ultra Sound (Booth 8)**

Phone: 914.666.6200  
www.universalultrasound.com

## **Wiley-Blackwell (Booth 9 & 10)**

Phone: 800.923.6211  
www.wiley.com/go/veterinary

\*Indicates 2009 ABVP Symposium sponsors.

## EXHIBITOR MAP

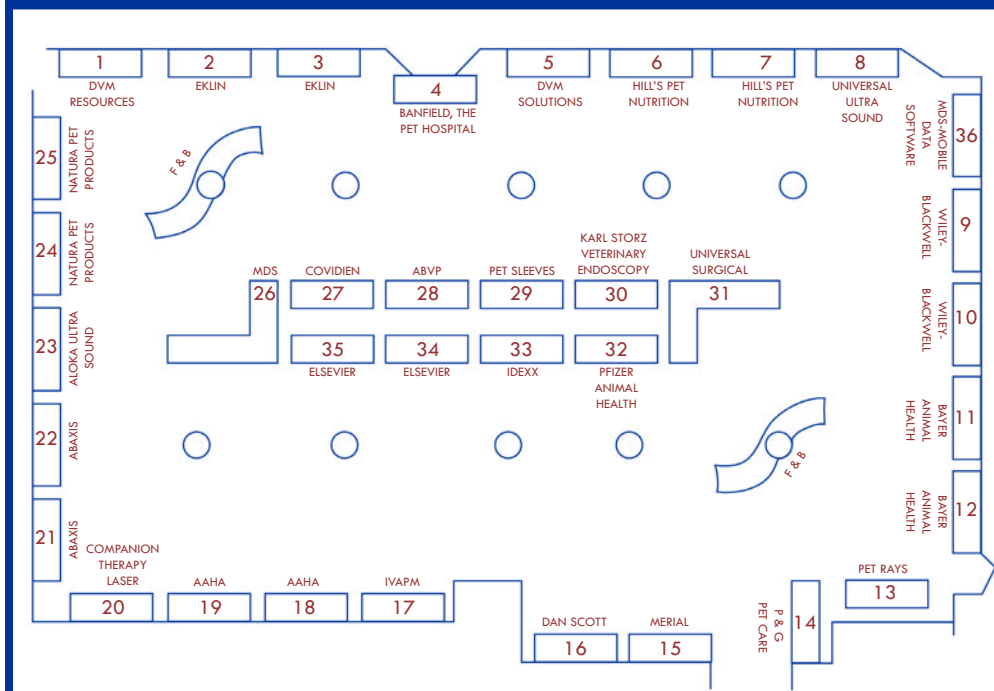

## 2009 SPONSORS

ABVP gratefully acknowledges our 2009 Symposium sponsors!

### CHARTER SPONSORS



Bayer



Animal Health

### SPONSORS



P&G Pet Care

